

R-4

History of original corner establishment:

Original survey by Manius Buchanan under contract No. 635, 1895.

Set a Tamarack Post 3 ft. long, 3 ins. square, 24 ins. ground for corner to Sec's 23,24,25 and 26, marked

T1N S24 on NE
R35E S25 of SE
S26 on SW and
S23 on NW faces with 2 notches on S and 1 on E edges,

from which:

- A Tamarack 14 ins. diam. bears N 60 1/2°E 52 lks. dist. marked T1N R35E S24 BT.
- A Pine 16 ins. diam. bears S 50°E 30 lks. dist. marked T1N R35E S25 BT.
- A Fir, 12 ins. diam. bears S 46°W 51 1/2 lks. dist. marked T1N R35E S26 BT.
- A Fir, 12 ins. diam. bears N 46°W 22 lks. dist. marked T1N R35E S23 BT.

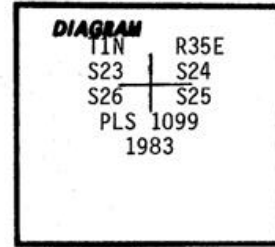

R-21

Description of corner evidence found:

- A Western Larch stump, rotted at ground level, size indeterminate, no markings found (orig. NE bearing tree)
 - A Ponderosa Pine stump, rotted at ground level, size indeterminate, no markings found (orig. SE bearing tree)
 - A Douglas Fir stump, rotted at ground level, size indeterminate, no markings found (orig. SW bearing tree)
 - A Douglas Fir stump, rotted at ground level, size indeterminate, with original blazed face lying alongside, scribing "R35E S23 BT" visible (orig. NW bearing tree)
- No evidence remains of the original corner post.

Description of monument and accessories established to perpetuate the original location of this corner:

At the corner point determined in the following relationship to the found remains of the original BT's, we set a 2"x30" galvanized iron pipe, 28" in the ground with brass cap attached, marked:

From which:

The original bearing trees as previously described:

- A Western Larch stump bears N 60 1/2°E 34.3 ft. to apparent face.
- A Ponderosa Pine stump bears S 48°E 19.8 ft. to apparent face.
- A Douglas Fir stump bears S 43°W 34.0 ft. to apparent face.
- And a Douglas Fir stump bears N 39°W 14.5 ft. to apparent face.

We mark new bearing trees:

- A 12" Douglas Fir, scribed "T1N R35E S26 BT" on a double blaze bears S81°W 21.4 ft.
- An 8" Grand Fir, scribed "T1N R35E S23 BT" on a double blaze bears N 45°W 16.2 ft.
- A 10" Western Larch, scribed "T1N R35E S24 BT" on a double blaze bears N 66 1/2°E 38.3 ft.
- And a 10" Douglas Fir, scribed "T1N R35E S25 BT" on a double blaze bears S 14°E 57.1 ft.

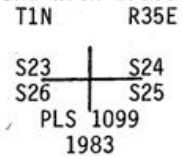

Attached brass washer, marked "LS 1099" to lower blaze of new BT's. Bearing and horizontal distance measured to center of bearing trees at ground level.

Staff Compass (20° East Declination) Steel Tape
October 7, 1983 Witnesses: Gary Langlitz LS 1099
Dick Humiston

Corner located 3 ft. E of N-S fenceline.

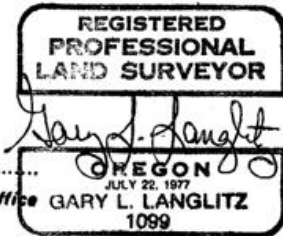

Office of Surveyor County of Umatilla
State of Oregon I hereby certify that the within instrument was filed in this office
for record on the 11th day of November, 1983
David Rumbert by Betty Cochran
(COUNTY OFFICIAL) (DEPUTY)