

D-17

OREGON CORNER RESTORATION FORM

Section 3 Township 1N Range 34E

County Umatilla Date 9/16/87

D-17

Corner Designation

S. 1/16 Corner  
between 3 and 2



- Condition Report Only
- Not Found
- Renewed
- Unrecorded
- Surveyed In
- Referenced Out

Previous Renewals/Surveys, etc.

Gov't. Indian Allotment survey, 1919.

Monument(s) & Accessories Found: (Condition and Source)

Found brass cap on 2" iron pipe in an open field.  
No BT's found.

Monument Detail

Sketch



Monument Set (Procedures and Description)

New Accessories

Location & Comments

Blue Mountain Forest  
Wayside boundary  
survey, SE 1/4 Sec. 4,  
and S 1/2 Sec. 3.

Compass Declination 20°

Firm/Agency Oregon State  
Parks & Recreation Div.

Address 525 Trade Street SE  
Salem OR 97310

Party Chief R. Hemmer

Notes R. Hemmer

Witness L. Boge, H. Hanson

Seal

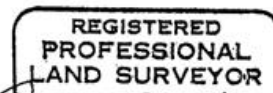

*John E. Hollingsworth*

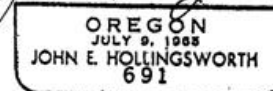

RECEIVED BY

Umatilla County Surveyor

Date 2-88

Rec'd By KA

No. 88-10-B