

OREGON CORNER RESTORATION FORM

Section 15 Township 1N Range 32E
 County Umatilla Date: September 10, 2009

Corner Designation: 1N32N15

Quarter corner common to sections 15 and 22,
 T1N, R32E, W.M., Umatilla County, Oregon.

Previous Renewals / Surveys, etc.

Corner originally set by Daniel Chaplin under contract No. 107 dated September 21, 1864.
 His record reads: Set post for 1/4 sec. corner in mound of earth with charred stake, with pits
 &c as per instructions. J. Kimbrell in record of survey in Book 1, Page 422 states: Set stone.
 Bill Wells, in Partition Plat 2009-19 computed a location for this corner but did not monument it.

Condition Report Only

- Not found
- Remonumented
- Unrecorded
- Surveyed in
- Referenced out

Monument and Accessories found: (condition and source)

I held the position from Partition Plat 2009-19. This point falls in a plowed field.

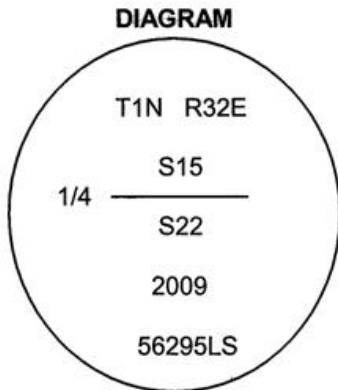

- ⊗ = Brass Cap
- = Rebar Reference
- = Steel Guard Post

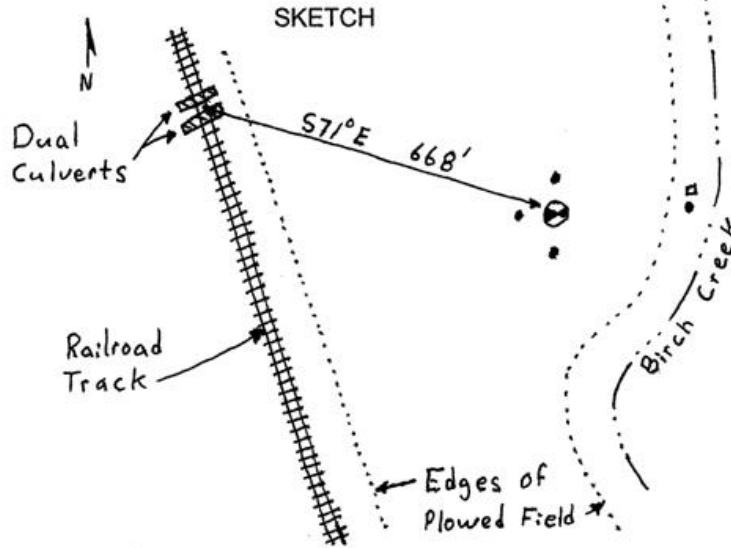

MONUMENT (S) AND ACCESSORIES SET (Procedures and Description)

At the position from Partition Plat 2009-19 I set a 1 1/2" x 30" galvanized iron pipe with a 2 1/2" brass cap stamped as shown in the diagram above. The cap is 24" below the surface of a plowed field.

For references, I set four 5/8" by 24" iron rebars with 1 1/4" orange plastic caps stamped WTS and 56295LS as described below:

- an iron rebar bears N88°24'11"W, 24.45 feet, 2 feet below the surface of the field;
- an iron rebar bears N11°55'07"E, 26.01 feet, 2 feet below the surface of the field;
- an iron rebar bears S89°19'03"E, 190.06 feet on a ledge above the west bank of Birch Creek;
- an iron rebar bears S11°17'43"W, 34.36 feet, 2 feet below the surface of the field;

The monument was set and references tied using a Trimble R7/R8 RTK GPS system.

Location and comments
 NAD 83/1991 State Plane Coordinates
 Oregon North Zone
 N = 694,381.24 ift
 E = 8,638,215.17 ift

Compass Declination
 Firm / Agency
 Witness Tree Surveying
 Address
 P.O. Box G
 Pilot Rock, Or. 97868
 Party Chief
 Stephen K, Haddock

Surveyors Seal

RECEIVED BY:
Umatilla County Surveyor
 Date: 6-10
 Rec'd By: KK
 No. 10-95-C

REGISTERED
 PROFESSIONAL
 LAND SURVEYOR

Stephen K. Haddock

OREGON
 JULY 9, 2001
 STEPHEN K. HADDOCK
 56295LS

RENEWAL DATE 6-30-11