

GPS CONTROL STATION

OREGON STATE PLANE, NORTH ZONE

STATION NAME: 71	GEODETIC COOR: NAD 83(91):
SECTION: NW 1/4, S9, T.2N., R.32E., UMATILLA COUNTY, OREGON	LAT: 45° 40' 19.25969" N LONG: 118° 49' 15.13222" W STATE PLANE CO-ORDINATES, NAD 83-91, INT.FT.:
DATE SET: MARCH 1996	N: 735566.938 E: 8631296.461 THETA: 1° 11' 26.94" SCALE FACTOR: 0.99993315 ELEV: 1021.93 US.FT. ELEV. DATUM: LOCAL, CITY OF PENDLETON
SURVEYOR: WILLIAM R. WELLS PLS 1106	CITY OF PENDLETON CO-ORDINATES INT.FT.:
FIRM: WILLIAM R. WELLS, LAND SURVEYING AND PLANNING P.O. BOX 1696 PENDLETON, OR 97801 (541) 276-6362	N: 51387.477 E: 39048.991
ORDER: SECOND ORDER, CLASS I	

LOCATION:

FROM HIGHWAY 30 TURN SOUTH THEN WESTERLY THEN SOUTH ON PAVED STREET WEST OF EASTERN OREGON CORRECTIONAL INSTITUTION. STATION IS WEST OF THIS STREET BETWEEN BASEBALL FIELD AND EASTERN OREGON PSYCHIATRIC CENTER. STATION IS SOUTH 32° EAST, 60 FEET M/L FROM DETOX CENTER SIGN. STATION IS SOUTH 40° WEST, 90 FEET M/L FROM A TREE NORTH OF EASTERN OREGON PSYCHIATRIC CENTER.

STATION IS A 5/8" X 30" IRON ROD WITH A YELLOW PLASTIC CAP MARKED "OR PLS 1106, WA PLS 17372".

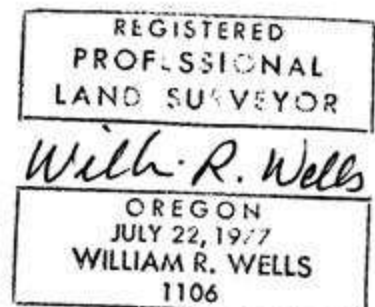

*Renews 6-30-96*