

TOWNSHIP 2 NORTH, RANGE 34 EAST, OF THE WILLAMETTE MERIDIAN, OREGON
DEPENDENT RESURVEY

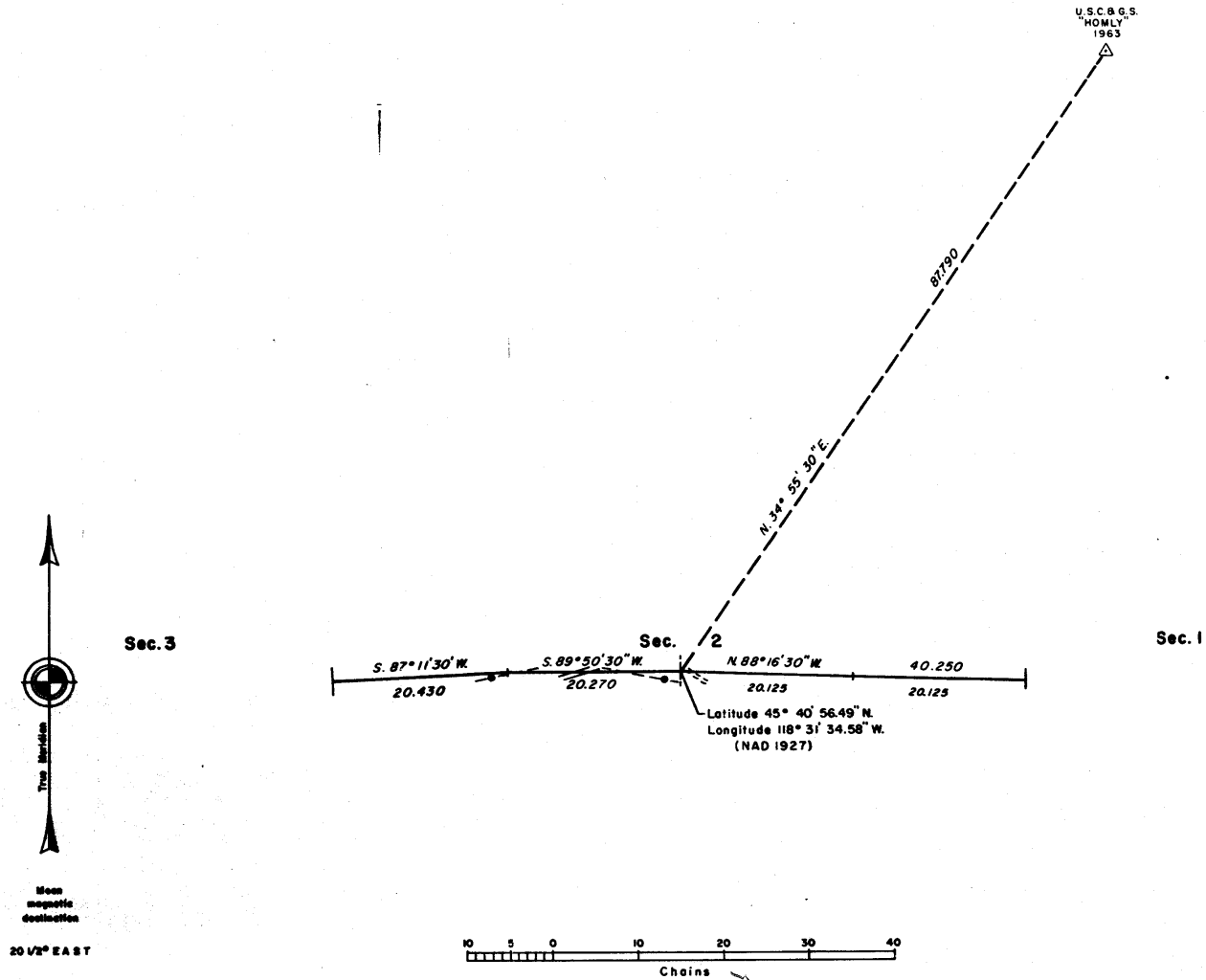

A history of surveys is contained in the field notes.

This plat represents a dependent resurvey of the east and west center line of section 2, T.2N., R.34E., Willamette Meridian, Oregon, designed to restore the corners in their true original locations according to the best available evidence.

The survey was executed by Richard L. Johnson, Cadastral Surveyor, beginning October 28, 1987, and completed October 29, 1987, pursuant to Special Instructions dated October 20, 1987, under Group Number 1418, Oregon.

Timber in this area consists of pine.

UNITED STATES DEPARTMENT OF THE INTERIOR
BUREAU OF LAND MANAGEMENT

Portland, Oregon February 10, 1989

This plat is strictly conformable to the approved field notes, and the survey, having been correctly executed in accordance with the requirements of law and the regulations of this Bureau, is hereby accepted.

For the Director

Wayne M. Anderson
Chief Cadastral Surveyor of Oregon

RECEIVED BY

Umatilla County Surveyor
Date 6-89
Rec'd by [Signature]
No. 89-58-B