

STATE OF OREGON, COUNTY OF UMATILLA }
I certify that this instrument was received and recorded
ON June 2, 2010
at 10:30 o'clock Am., in the record of PLATS of said County.
YEAR NUMBER Slide
2010 09

OFFICE OF COUNTY RECORDS
By: JEAN HEMPHILL, Records Officer
Fees \$ 65.00 No. 2010-5660351

REGISTERED PROFESSIONAL LAND SURVEYOR
OREGON
JULY 26, 1988
PAUL W.P. TOMKINS
2360
RENEWS 6/30/2010

Date Stamped: 4/26/10
USKH
Engineering • Land Surveying
Planning • Materials Testing
5 North Coville St.
Walla Walla, WA 99362
Phone: (509) 522-4843
Fax: (509) 522-1902

Project:
A PARTITION PLAT OF PARCEL 3 OF SURVEY 09-92-B LOCATED IN THE SE 1/4, SE 1/4 AND THE SW 1/4, SE 1/4 OF SEC. 5, THE NW 1/4, NE 1/4, THE NE 1/4, NE 1/4, THE SW 1/4, NE 1/4, THE SW 1/4, NE 1/4, THE NW 1/4, SW 1/4, THE NW 1/4, SE 1/4 OF SEC. 8 ALL IN T5N, R35E, W.M., UMATILLA COUNTY, OR.

Client:
BOB BUCHANNAN
NORTH SLOPE PROPERTIES
83501 LOWER DRY CR. RD.
MILTON FREEWATER, OR 97862

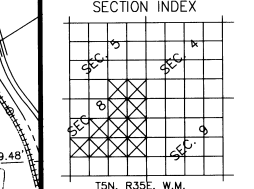

Project Mgr. PWPT
Drawn PWPT
Checked
Date APRIL-26-10
Scale 1" = 500'

CAD File: OCTAVE-XL-SERRA PART.DWG
Sheet Contents: Survey Map
Sheet No.: 6-10
U.S.K.H. W.O. 909701

DRAWING NAME: I:\909701\Survey\Drawgs\OCTAVE-XL-Serrapadace PART.dwg PLOTTED: Apr. 26, 2010 - 10:52am

HOMeward BOUND-XL-SERRA PEDACE PARTITION PLAT
UMATILLA COUNTY PARTITION PLAT 2010-09 2 of 2

STATE OF OREGON }
COUNTY OF UMATILLA }
I certify that this instrument was received and recorded
ON June 2, 2010
at 10:30 o'clock Am., in the record of
PLATS of said County.
YEAR NUMBER Slide
2010 09 09
OFFICE OF COUNTY RECORDS
By: JEAN HEMPHILL, Records Officer
Fees \$ 65.00 No. 2010-5660351

REGISTERED
PROFESSIONAL
LAND SURVEYOR

OREGON
JULY 26, 1988
PAUL W.P. TOMKINS
2360
RENEWS 6/30/2010

Date Stamped: 4/23/10

USKH
Engineering • Land Surveying
Planning • Materials Testing
 5 North Colville St.
Walla Walla, WA 99362
Phone: (509) 522-4843
Fax: (509) 522-1902

Project:
A PARTITION PLAT OF PARCEL 3
OF SURVEY 09-92-B LOCATED
IN THE SE 1/4, SE 1/4 AND
THE SW 1/4, SE 1/4 OF SEC.
5, THE NW 1/4, NE 1/4, THE
NE 1/4, NE 1/4, THE SW 1/4,
NE 1/4, THE SE 1/4, NE 1/4,
THE NW 1/4, SW 1/4, THE NE
1/4, SW 1/4, THE NW 1/4, SE
1/4, AND THE NE 1/4, SE 1/4
OF SEC. 8 ALL IN T5N, R35E,
W.M., UMATILLA COUNTY, OR.

Client
BOB BUCHANNAN
NORTH SLOPE PROPERTIES
83501 LOWER DRY CR. RD.
MILTON FREEWATER, OR 97862

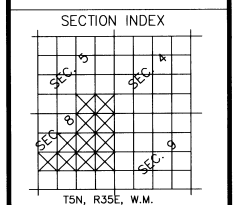

Project Mgr.	PWPT
Drawn	PWPT
Checked	
Date	APRIL-26-10
Scale	1" = 500'
CAD File: OCTAVE-XL-SERRA PART.DWG	
Sheet Contents: SURVEY MAP	
Sheet No.:	2 OF 2
Project No.:	909701

APPROVALS
APPROVED THIS 2nd DAY OF June
2010, IN ACCORDANCE WITH UMATILLA COUNTY
DEVELOPMENT CODE,
[Signature]
UMATILLA COUNTY PLANNING DIRECTOR
APPROVED THIS 10 DAY OF May
2010, IN ACCORDANCE WITH THE UMATILLA
COUNTY DEVELOPMENT CODE.
[Signature]
UMATILLA COUNTY SURVEYOR

TAX COLLECTOR'S CERTIFICATE
I HEREBY CERTIFY THAT ALL TAXES FOR THE YEAR
2009-2010 AGAINST THE PROPERTY SHOWN
HEREIN HAVE BEEN PAID.
[Signature] 5/3/2010
UMATILLA COUNTY TAX COLLECTOR DATE

OWNERS' DECLARATION
KNOW ALL MEN BY THESE PRESENTS THAT I, NORM MCKIBBEN,
MANAGING PARTNER FOR VINEYARD GROUP, L.L.C., OWNER, HAVE
CAUSED THESE LANDS TO BE SURVEYED AND SUBDIVIDED AS
SHOWN, AND DO HEREBY DEDICATE THE PARTITION PLAT TO
UMATILLA COUNTY, OREGON.
[Signature]
NORM MCKIBBEN, MANAGING PARTNER FOR VINEYARD GROUP, LLC
DATE 5/3/2010

ACKNOWLEDGEMENT
STATE OF WASHINGTON
COUNTY OF WALLA WALLA
BEFORE ME THIS 3 DAY OF May, 2010 APPEARED
NORM MCKIBBEN, MANAGING PARTNER FOR VINEYARD GROUP, LLC,
TO ME PERSONALLY KNOWN, WHO ACKNOWLEDGED THE FOREGOING
PARTITIONING OF LAND TO BE A FREE AND VOLUNTARY ACT AND
DEED.
WITNESS MY HAND AND OFFICIAL SEAL THIS 3 DAY OF
May, 2010.
MY COMMISSION EXPIRES June 1, 2012
[Signature]
NOTARY PUBLIC FOR THE STATE OF WASHINGTON, RESIDING IN
Wenatchee, WA



I CERTIFY THIS IS A TRUE AND EXACT
COPY OF THE ORIGINAL PLAT.
[Signature]
PAUL W.P. TOMKINS, P.L.S. 2360
Umatilla County

DRAWING NAME: I:\909701\Survey\Draws\OCTAVE-XL-Serrapedace PART.dwg PLOTTED: Apr. 26, 2010 - 10:53am

Scale 6-10
Sheet No. KK
Date 10-10-10-B