

289

Plat of Road Survey No 289.
Umatilla Co. Oregon.

Township No. 2N

Range 31 E. W. M.

T2N R31E

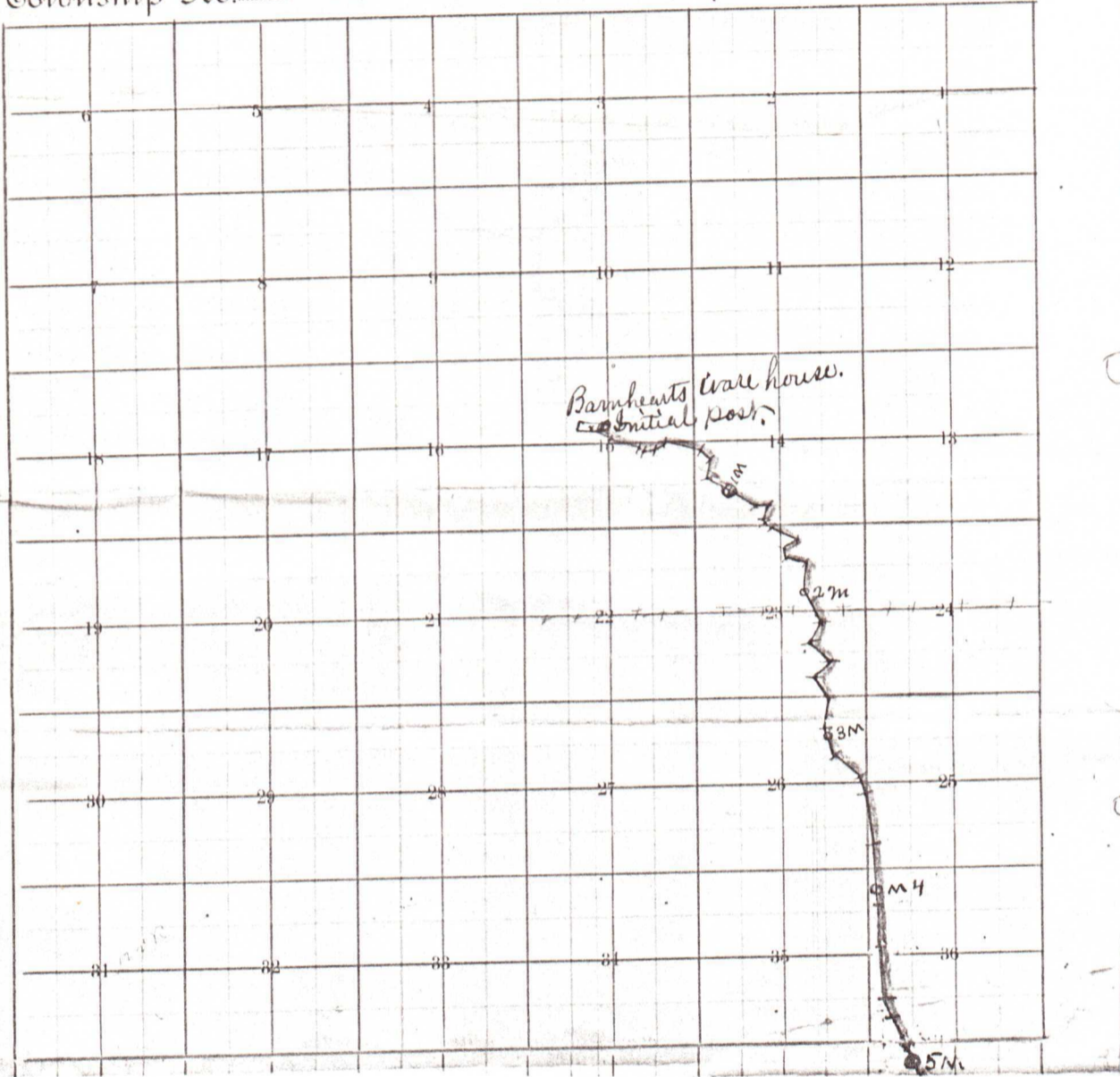

FIN 31E

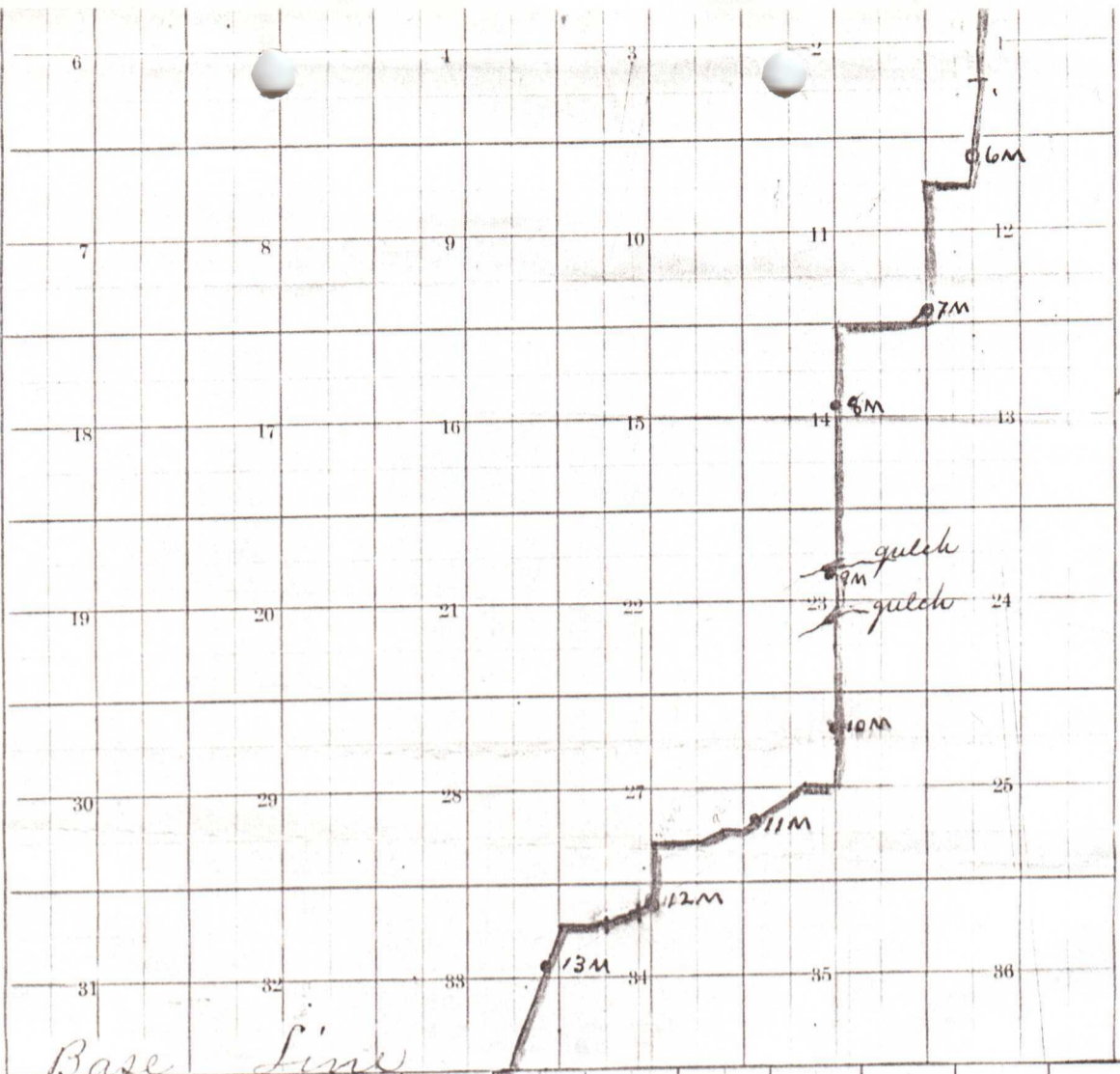

Base Line

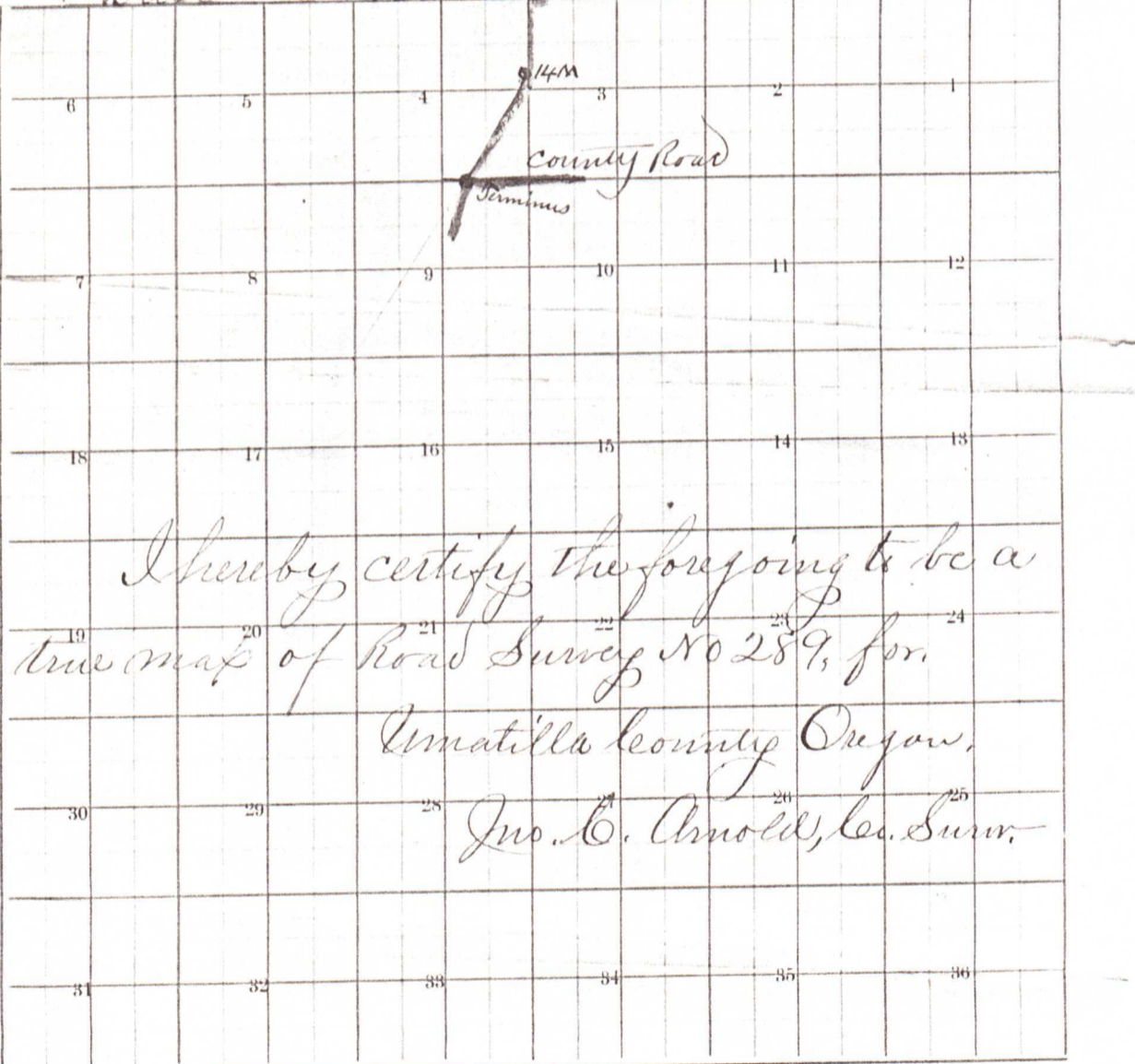

I hereby certify the foregoing to be a
 true map of Road Survey No 289, for
 Umatilla County Oregon,
 Jno. C. Arnold, Lec. Surv.