

401

TOWNSHIP 6 N. RANGE 35 E. W. M.

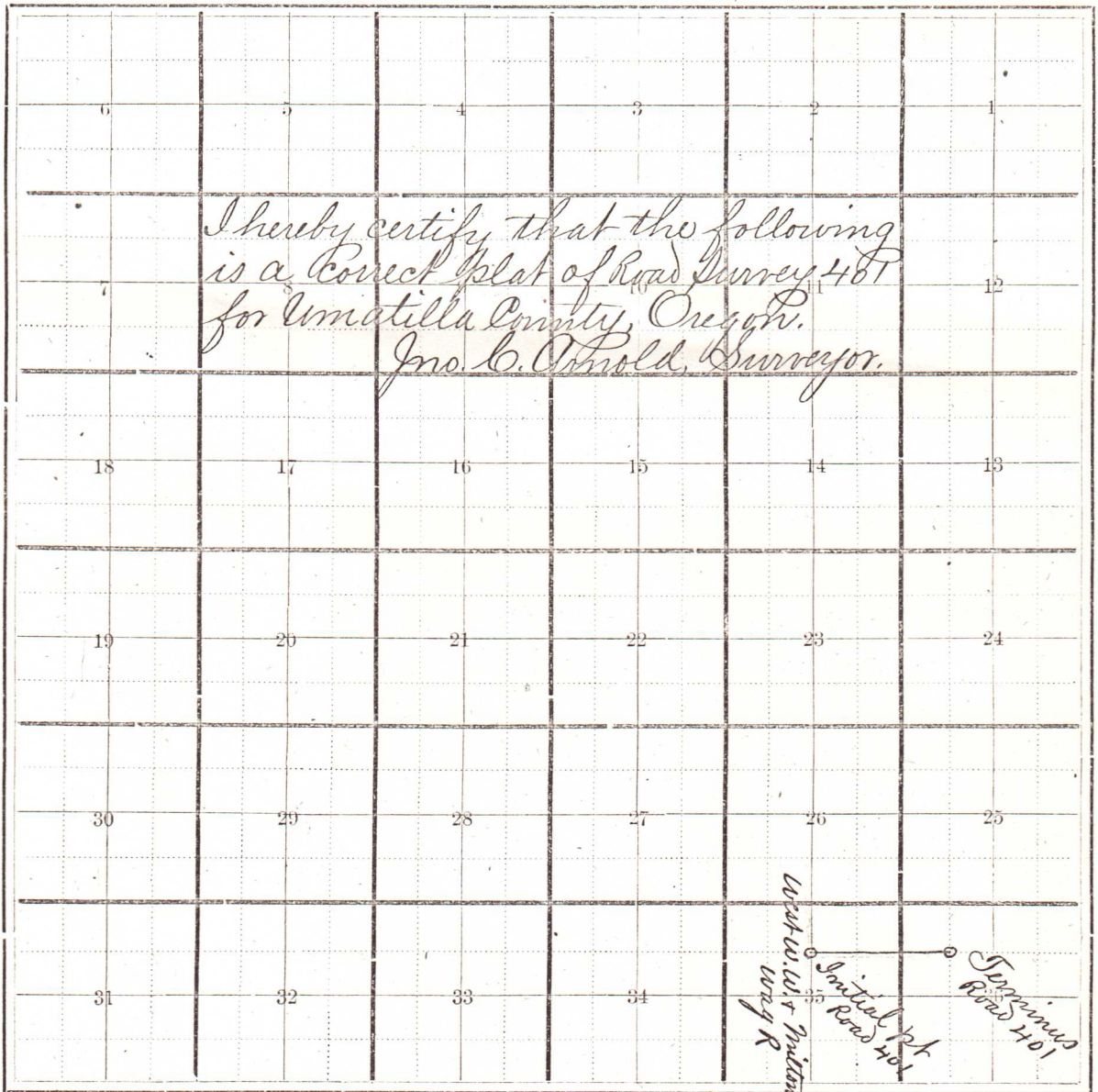

NOW, THE CONDITION OF THE ABOVE OBLIGATION IS SUCH, That, whereas the above named

*N. M. Gerking*

and

*P. M. Gerking*

and others,

have petitioned the County Court of said County of Umatilla, at the *July* Term, 1882, thereof, for a County Road, commencing *in the center of the west line of the N.E. 1/4 of Sec. 35, in Twp. 6 N. of Range 35 E. W. M., running thence east three fourths of a mile to the center of the N.W. 1/4 of Sec. 36 in Twp. and Range aforesaid*

NOW, if the above named

*N. M. Gerking*

and

*P. M. Gerking*