

PLAT AND RECORD OF SURVEY No. 7739

Survey for J. J. Boulton. Feb. 25<sup>th</sup> 1885

Course. Degree. Minutes. Chain. Links.

Subdivision of Secs 7 and 12 T. 3. N. Range 33. and 34  
in order to establish the corners to the N.W. 1/4 of sec 7  
and the N.E. 1/4 of sec 12

East

38 13 come upon 1/4 S. corner which  
I saw by setting a 20" x 9" x 12"  
From N.W. cor. of sec 7 I  
run West

West

27 92 intersect gov. cor. marked by rock  
Thence East on true line

East

38 96 set a rock 25" x 8" x 10" for 1/4 sec. cor.  
the old government corner being  
wholly obliterated.  
From N.W. cor. of sec 7  
I run South on direct  
line and at

South  
North

80 14 Intersect government cor. at S.E. cor. of sec. 12 - Thence North  
40 07 set a rock 25" x 10" x 10" for the 1/4 S. cor. between sec 7 and 12 the old corner being lost  
From the S.E. cor. of sec 12 I run West

West

39 66 come upon the 1/4 S. post  
37 32 come upon the S.W. cor. of sec 12 - Thence North on true line  
80 18 intersect sec. cor. Thence South on true line and at  
40 07 set a rock 16" x 8" x 12" for 1/4 S. cor. which had disappeared in road.  
Having now either found the old government quarter section  
corners or established them by actual survey I proceed to  
locate the quarter section corners at the centers of

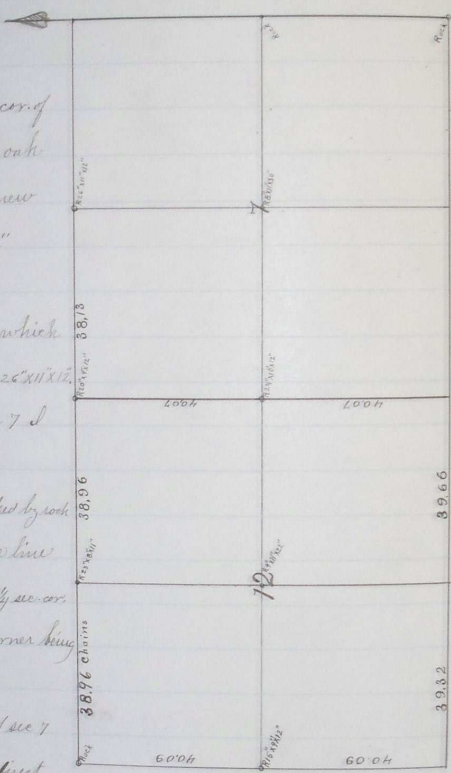

## PLAT AND RECORD OF SURVEY No. 7119

Chains	Links	Degrees	Minutes	Seconds

sections 7 and 12 by running straight lines across each section north and south and east and west between the quarter section corners and placing the corners at the intersection of these lines. Having made the intersections I set a rock 8" x 11" x 30" at the center of section 7 and a rock 9" x 11" x 22" at the center of section 12.

I hereby certify the foregoing record and plat to be true

P. Zahner Sept Co. Surveyors