

ed
n.f.
on
20
owl
to
wate
uted

NE Corner of SE 1/4 of NE 1/4 of Sec 21
From R 30 E 1/2 S of R 30 E

386 Ft

50 Vinson St

(County Road

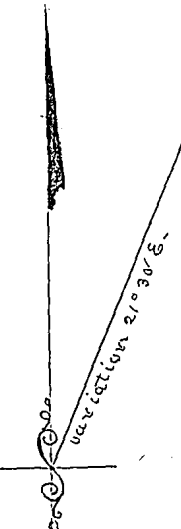
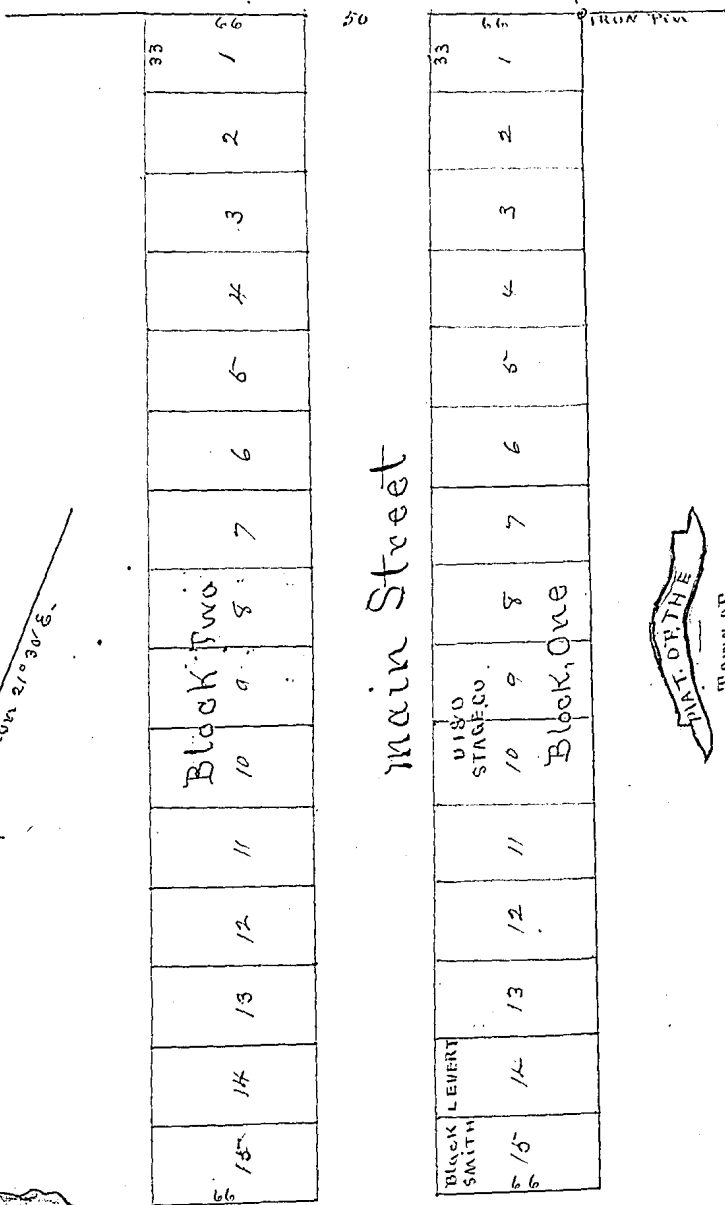

SCALE 50 FEET TO 1 INCH

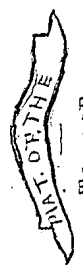

BUTTER CREEK

UMATILLA COUNTY
OREGON
1880

DRAWN BY CHAS. F. SEARS, C.E.

AUG 12, 1880

Butter Creek Aug 13th 1880

Description of Survey of the Town site of Butter Creek, Umatilla County State of Oregon being situated in the East half of the SE 1/4 of the NE 1/4 of Section 21 Township one south R. 30 East