

State Highway Designation  
Resolution No. 96

Cross Reference  
Jurisdictional Transfer No. 739

**State Highway Designation Resolution and  
Minor Amendment to the Oregon Highway Plan**

**Thielson Road (M.P. 12.70 to M.P. 35.70)  
Lexington-Echo Highway  
State Highway No. 320  
Umatilla County**

THIS RESOLUTION is made by the STATE OF OREGON, by and through its Oregon Transportation Commission, herein referred to as "State".

WHEREAS, pursuant to ORS 366.215, the State may select, establish, adopt, layout, locate, alter, relocate, change and realign primary and secondary state highways.

WHEREAS, pursuant to ORS 366.220(1), the State may select, establish designate, construct, maintain, operate and improve or cause to be constructed, maintained, operated and improved a system of state highways within the state, which highways shall be designated by name and by the point of beginning and terminus thereof.

WHEREAS, the State wishes to designate a portion of Thielson Road (County Road No. 1300) as the Lexington-Echo Highway, State Highway No. 320.

WHEREAS, it is the judgment of the Oregon Transportation Commission that it is in the best interests of the people of the State of Oregon that the above-named county road be placed on the state highway system and be designated as a state highway.

WHEREAS, the Oregon Transportation Commission and the City have entered into an agreement on September 8, 2003 to transfer Thielson Road, County Road No. 1300, MP 12.70 to MP 35.70 to the State and

WHEREAS, the Oregon Transportation Commission (Commission) has found that this highway segment is needed as a portion of the state highway system, and

WHEREAS, the 1999 Oregon Highway Plan is the highway element of the state transportation system plan required by Section 1204 of the Transportation Equity Act for the 21<sup>st</sup> Century, ORS 184.618(1), and the state Transportation Planning Rule. It is a statement of

state policy adopted by the Transportation Commission and serves as the Highway Modal System Plan for the State of Oregon. The description of the state highway system and assigned function of each state highway is part of the Oregon Highway Plan. Since a highway designation involves a change to the highway system, the Oregon Highway Plan requires an amendment to reflect the current state highway system.

In accordance with Oregon Highway Plan Policy 2C, Interjurisdictional Transfers, the Oregon Transportation Commission finds the following:

1. This segment of highway serves state interests and functions as a District Highway in the Oregon Highway Plan. The purpose of District Highways is to provide connections and links between small urbanized areas, rural centers and urban hubs and serve local access and traffic. Since this highway serves primarily regional and statewide traffic, the Oregon Transportation Commission finds that this segment of roadway is needed to meet the functional needs of the state system.
2. The Oregon Transportation Commission approved the designation and transfer at their meeting on June 18, 2003 after public notice was given as part of the regular Commission agenda.
3. Notice of completion of the designation and transfer was emailed to the Department of Land Conservation and Development on November 9, 2007.
4. Both the County and the Oregon Department of Transportation agreed in writing to the designation and transfer.
5. The intergovernmental agreement with the City addresses access rights, access management controls, roadway conditions, compensation, and maintenance and operational standards as necessary.
6. This transfer is consistent with the State Agency Coordination Rule OAR Chapter 731, Division 15. This transfer is a minor amendment to the Highway Plan since the change transfers jurisdiction of the facility without changing the functional classification of the roadway.

THEREFORE, IT IS HEREBY RESOLVED BY THIS COMMISSION AS FOLLOWS:

1. That Thielson Road (M.P. 12.70 to M.P. 35.70) is hereby designated as the Lexington-Echo Highway, State Highway No. 320. Said road is described as follows:

State Highway Designation  
Resolution No. 96

Cross Reference  
Jurisdictional Transfer No. 739

All land within the right of way boundaries of Thielson Road, County Road 1300, as presently located, beginning at the intersection with State Highway No. 320 at milepoint 35.70, Engineer's Station 24+15, Northwest to the Umatilla - Stanfield highway milepoint 12.70, Engineer's Station 'A' 34+50 on ODOT map # 9B-29-7, located in Section 9 and 16, T3N R29E, W.M., Umatilla County.

2. That the portion of Thielson Road herein designated as the Lexington-Echo Highway, State Highway No. 320, is shown on Exhibit B attached hereto and by this reference made a part hereof.

NOW, THEREFORE, under the authority delegated by the Oregon Transportation Commission to the Director in Delegation Order No. 2 dated June 18, 2003, this Resolution and Amendment is hereby approved.

Signed

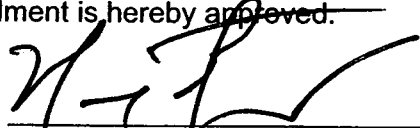
  
Matthew L. Garrett  
Director of Oregon Department of Transportation

Dated

11-14-07

T. 3 N., R. 29 E., W.M.

### EXHIBIT B

OREGON DEPARTMENT OF TRANSPORTATION

## JURISDICTIONAL TRANSFER NO. 739

### LEXINGTON - ECHO HWY. NO. 320 (M.P. 35.70) -

### UMATILLA - STANFIELD HWY. NO. 54 (M.P. 12.70) SECTION

THIELSON ROAD (COUNTY ROAD NO. 1300)

CITY OF ECHO  
UMATILLA COUNTY

UNIT C

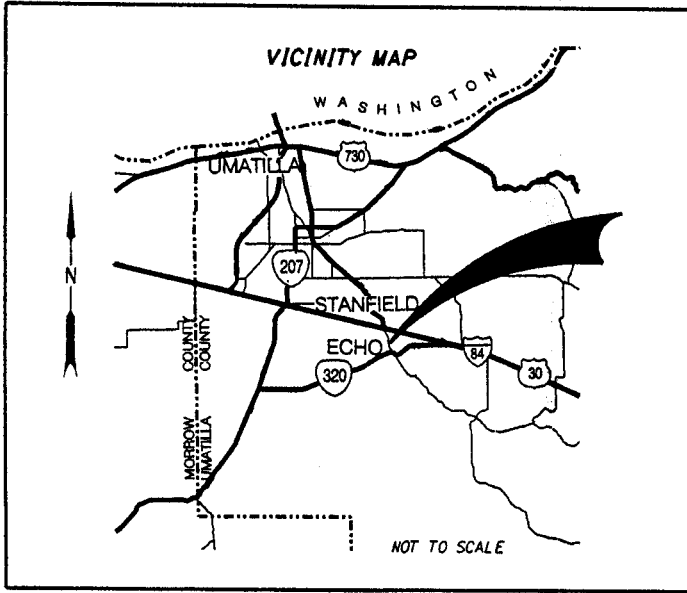
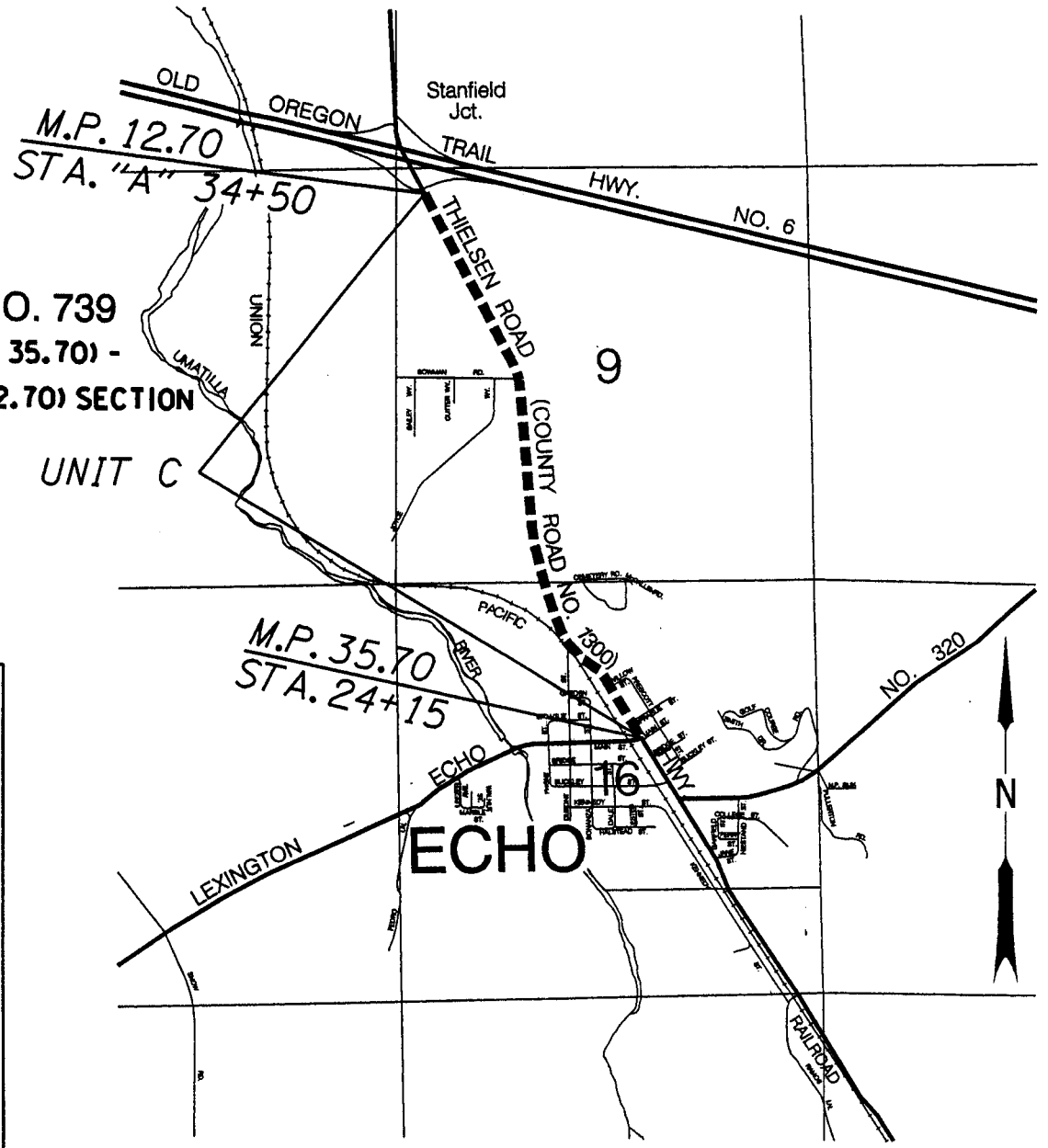

NOT TO SCALE