

WASHINGTON

STATE

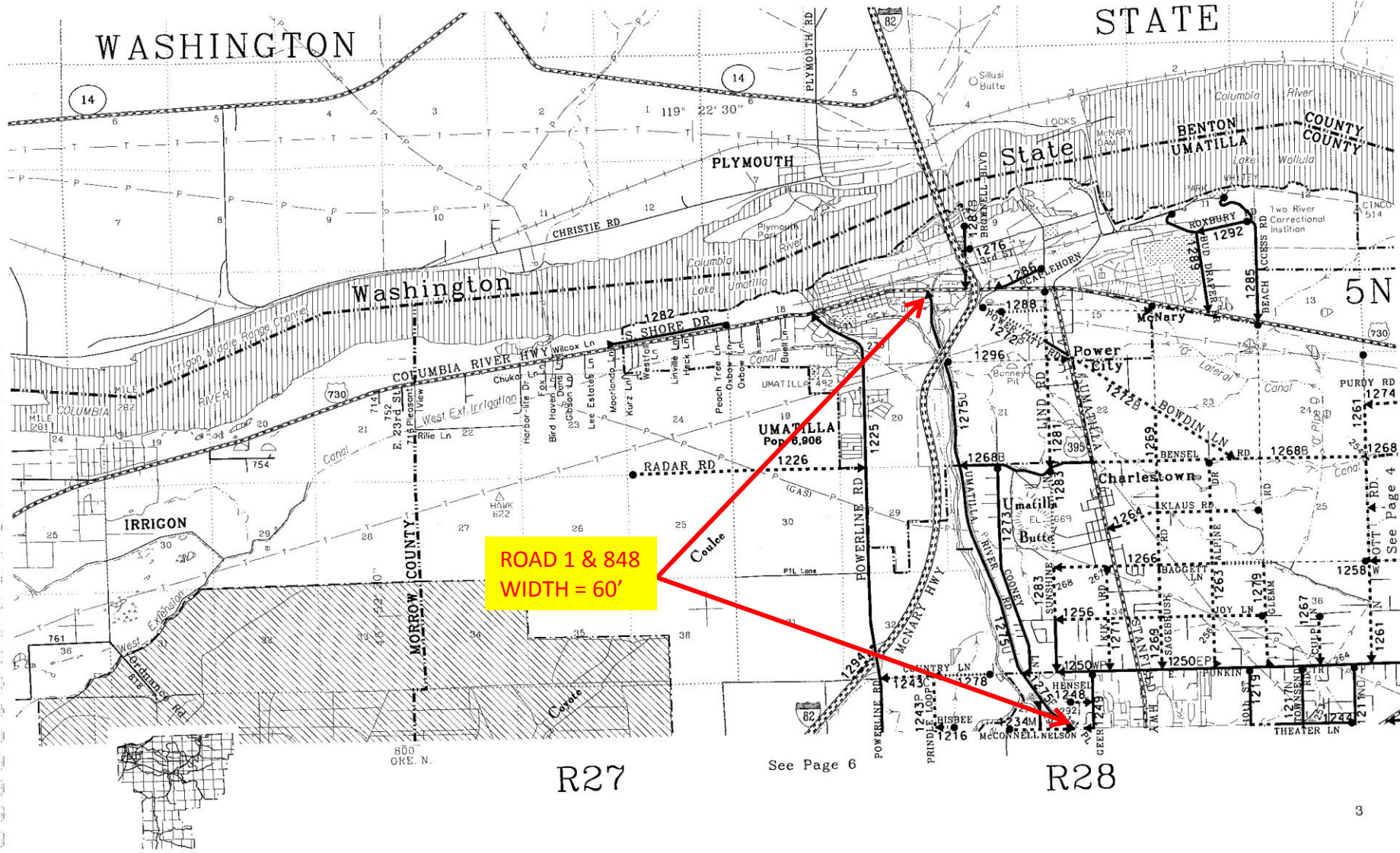

**ROAD 1 & 848
WIDTH = 60'**

R27

See Page 6

R28

- Walker Rd 1231
- Westland Rd 1215WE
- 1st Pl (N) 1275-1
- 1st St (S) 1245-1
- 2nd St (NE) 1227
- 4th St (SE) 1193
- 9th St (SE) 1197
- 10th St (NE & SE) 1219
- 10th St (SW) 1297
- 11th St (NW) 1247
- 17th St (SW) 1189
- 23rd St (SW) 1238-23

**ROAD 848 & 1
WIDTH = 60'**

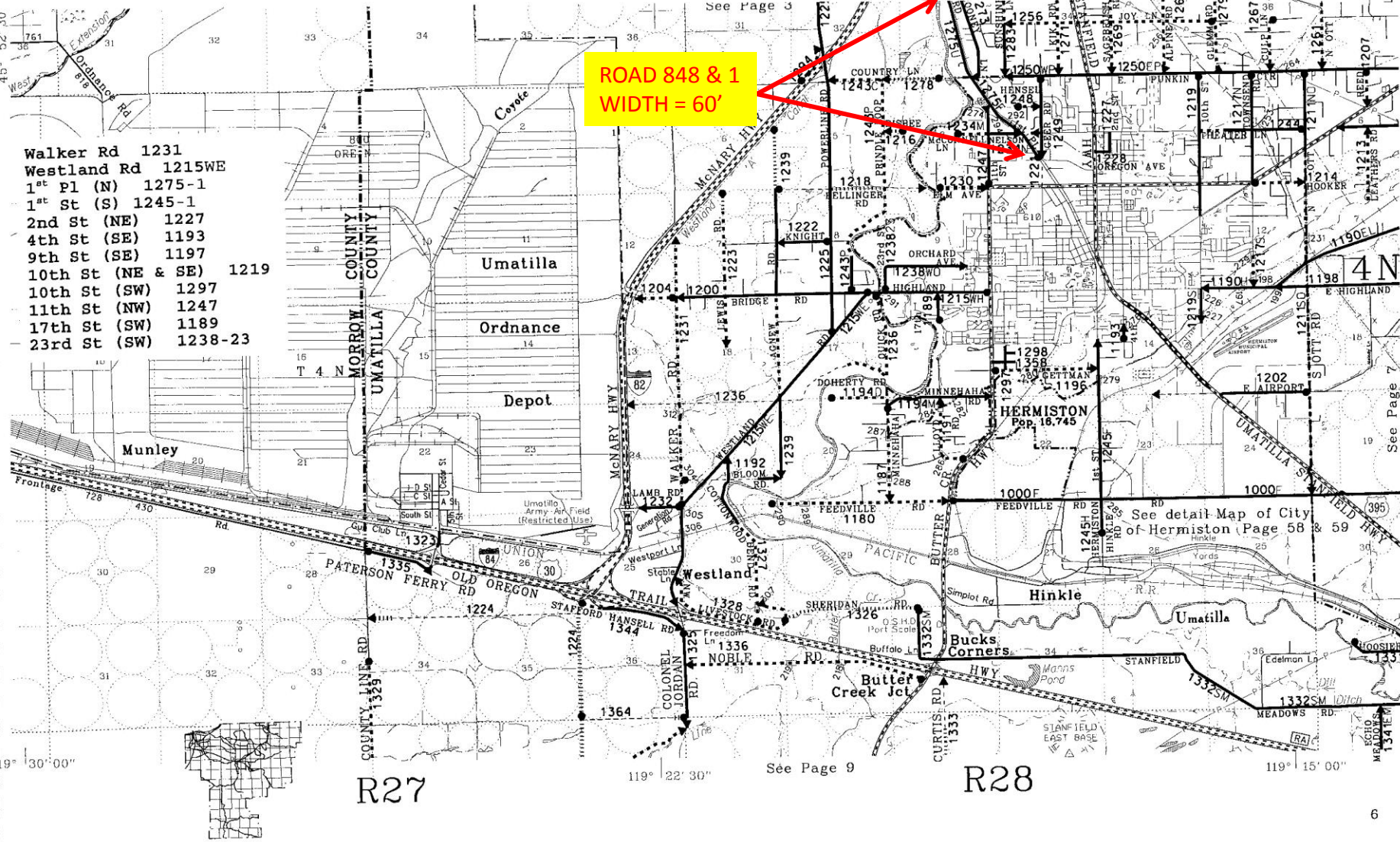

See Page 3

See Page 7

See Page 9

R27

R28