

- Walker Rd 1231
- Westland Rd 1215WE
- 1st Pl (N) 1275-1
- 1st St (S) 1245-1
- 2nd St (NE) 1227
- 4th St (SE) 1193
- 9th St (SE) 1197
- 10th St (NE & SE) 1219
- 10th St (SW) 1297
- 11th St (NW) 1247
- 17th St (SW) 1189
- 23rd St (SW) 1238-23

**ROAD 610
WIDTH = 66'**

See detail Map of City
of Hermiston (Page 58 & 59

R27

R28

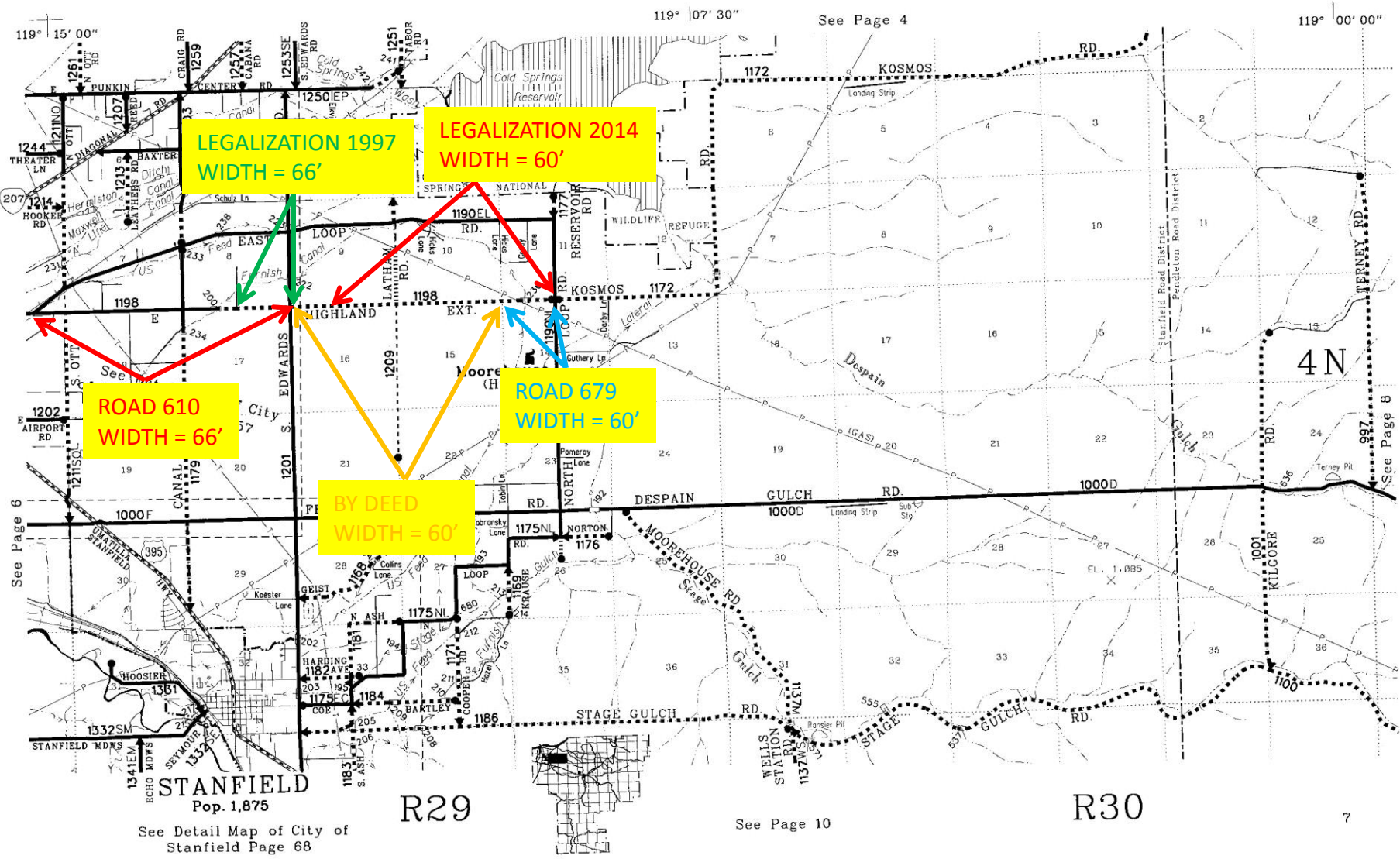

119° 107' 30"

See Page 4

119° 00' 00"

**LEGALIZATION 1997
WIDTH = 66'**

**LEGALIZATION 2014
WIDTH = 60'**

**ROAD 610
WIDTH = 66'**

**ROAD 679
WIDTH = 60'**

**BY DEED
WIDTH = 60'**

See Page 6

See Page 8

STANFIELD
Pop. 1,875
See Detail Map of City of Stanfield Page 68

R29

See Page 10

R30