

Report of Viewers. Field Notes and Plat of Survey of County Road leading from Cold Spring to Pine Creek. Road No 168

To the Hon County Court for Umatilla County Oregon.

We the undersigned having been appointed by your Hon. body to view out and survey a change in said Road No 168 being at a point 200 yards South of 1/2 mile stake on the East boundary of Sec 7 Tp 5 N. R 33 E. and being on a N. westerly direction to intersect the six mile post.

We met at the time and place appointed and after being qualified according to law by A. C. Coffey County Surveyor, we called to our aid W. W. Caviness and G. B. Clarke as chairman and Benj Stanton as marker, we proceeded to view out and survey said Road as set forth in the Order, we find the proposed road a good practical road and easily opened and much needed.

We would ask that the petition for said road be granted, this 26<sup>th</sup> day of July 1883.

Viewers { W. W. Caviness  
Benj Stanton  
Geo B. Clark

No 168

Course commencing at a point 200 yards South of the 1/4 Sec Corner on the East line of Sec 7. Tp 5: N. R. 33 E. of W. M., by planting a post marked R. from which we run N. 40. W

N 40 W. 11.00 Angle thence  
North 47.50 Angle "  
N 70 E 61.50 " "  
N 26 E 67.00 Intersect Road at the 6 mile post which we marked with the letter R.

Tp 5. N. R 33 E.

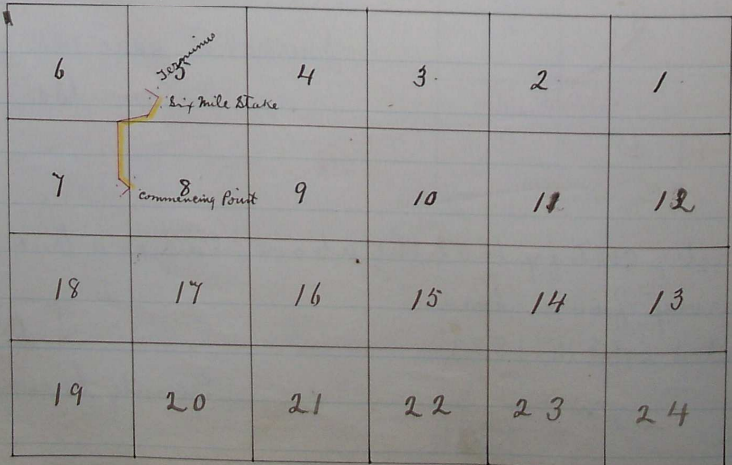

This Road void See Circuit Court Journal "C" page 655

ROAD No 158

I her and return this  
Journal  
Rec  
Rep  
comm  
Walla  
We  
survey  
1/4 of  
W  
quall  
callo  
and fo  
said  
that  
open  
for  
th  
Rea

I hereby certify that the within is a true and correct Survey and return of the within Road No 168. this 8<sup>th</sup> day of August 1883

A. L. Coffey, County Surveyor of Umatilla County Oregon

Journal F page 65-65  
" F " 1397/140

Recorded October 2<sup>nd</sup> 1883

J. P. Bushee  
Clerk

ROAD No

158

Report of Viewers. Field Notes and Plat of Survey of County Road commencing at S. E. corner of N. W 1/4 Sec 27. and connecting with the Walla Walla and Pendleton Stage Road. Road No 158.

To The Hon. County Court for Umatilla County, Oregon.

We the viewers appointed by your Hon body to view out and survey a County Road commencing at the S. E. corner of the N. W 1/4 of Sec 27 Tp 5. N. R. 35 E.

We met at the time and place appointed and after being qualified by A. L. Coffey, County Surveyor, according to law we called to our aid F. Linkmeyer and Robert Still as chaimmen and J. K. Johnson as marker we proceeded, view out and survey said Road as set forth in the petition. we further report that we find the Road a good practicable road and easily opened and much needed and we would ask that the petition for said road be granted.

this 23<sup>rd</sup> day of July 1883

J. K. Johnson } Viewers  
Robert Still }  
F. Linkemeyer }

Field notes of Road No 158

Beginning at S. E. corner of the N. W 1/4 of Sec 27 Tp 5 N. R. 35 E. planted post marked R. from which we run.