

ROAD NO

337.

## Road No 337.

Report of Viewers, Field Notes and Plat of Survey of a County Road Commencing at a post commonly known as the 5 mile post in the South East quarter of the North West quarter of Section 30 or in Township Three North of Range Thirty Six E.W.M. From thence running South Easterly to the Center of Section 4 Tp 3 N.R. 36 E.W.M. Thence due East as near as practicable four and one half miles to the one half mile stake on the line between Section 5 and 6 in Tp 3, NR. 37 E.W.M.

## - Report of Viewers -

To the Hon County Court Matilla County Or  
We the undersigned, viewers on Road survey no 337 would report that we met Geo L. Arnold, surveyor at the time and place appointed for the same and were qualified according to law. We called to our aid Edgar Thompson and Ernest Shepherd to chain and Geo A Brutscher Hemon Shepherd, Sebastian Brutscher, Joseph Hastings and Benjamin Halffer to mark and assist in cutting out the line of the road

We find the route to be quite a practicable one for the mountains it is more than ordinarily good, but little grading will be necessary. The main expense in opening the road will be in cutting away the timber and brush as there is a dense undergrowth of brush throughout the whole road. We ran an East course from each  $\frac{1}{4}$  sec cor on the line of the road, which did not prove to be the true center line of the Section in Sections 1, in R 36 and 6 in R 37 but since our order did not require us to determine the center Sec line, and to do which would require several days of expensive surveying on account of the dense growth of underbrush, and since the random East line referred to were near the center Sec line if not the true lines through the center of the sections referred to, we located said road upon the random <sup>East</sup> lines referred to. We find roads in this vicinity to be scarce and that road no 337 is much needed. We would therefore recommend that said road no 337 be declared a Public Highway.

all  
his 3

Apper  
1. The  
as the  
and t  
2. The

is no  
as pe  
able  
Sh  
be K  
or a

Dited  
G.A. Ho

-> Fi

-D-  
for d  
Court,  
viewe

all  
to cha  
of the  
under  
shephe  
as av  
directe

D. fi  
travell  
T. 3 NR  
Dane  
250  
800  
1137  
1360  
183

567 27 E  
17 800 060

Witness our respective hands at Dabbs Saw mill  
this 30<sup>th</sup> day of June 1890

Robert Jamison  
Boston Duvr  
James Kirkpatrick.

Append notes

1. The said road No 337 is but about one half as long as the old road made by teamsters in getting wood and timber from the mountains.
2. The Old timber road not being a County road is not kept in condition for travel at all times as persons work on the same only to make it passable for teams for the times being

If made a County road the same could easily be kept in good condition by applying the taxes or a portion of them on the road

Robt Jamison  
Boston Duvr  
James Kirkpatrick.

Dated July 7-1890 }  
G.A. Hartman Clerk }

→ Field Notes of Road Survey No 337 for Umatilla Co Or. ←

I met the full board of viewers on R No 337 for Umatilla Co Or as per order of County Court, June 28<sup>th</sup> 1890 and administer usual road viewers oath to each.

We call Edgar Thomson and Ernest Shepherd to chain and Geo A. Britcher to mark. On account of the exceeding amount of timber and dense underbrush we call Sebastian<sup>Call</sup> Britcher, Homer Shepherd Joseph Hastings and Benjamin Harffer as ar men, each assistant was qualified as directed by law.

I find old road post marked VM on S face on travelled road near center of SE 1/4 of NW 1/4 of Sec 4 T. 3 NR. 36 E. and set initial post 20 feet South of same. On var 20° with a Mason Theodolite I run

- |             |      |  |
|-------------|------|--|
| S 67° 22' E | 250  | Through scattering brush & timber to head of Draw N.   |
|             | 800  | Reputed center of Section 4 very much brush            |
|             | 1137 | Set angle post and turn 32° 30' left through brush     |
| N 80° 08' 3 | 1360 | Head of brushy draw, course N.                         |
|             | 1812 | Set angle post on beautiful knoll 6 ft high and 10 dia |

affording a slight opportunity to see over the brush. I turn thence Right  $10^{\circ} 45'$  descend through brush

- S  $89^{\circ} 07' E$  19'24 Head of graded road down brushy hill.
- 24'25 Down grade to S fork of Pine Creek bridge 1/2 wide of logs <sup>and</sup> brush
- 28'50 Set angle post and turn  $11^{\circ} 22'$  left through brush
- N  $79^{\circ} 31' E$  3400 Cor for 1/4 S bet Decs 3 & 4 in burnt brush. Set angle post at cor and turn on var  $20^{\circ}$  rand 1/2 sec line
- East 52'80 Det 1 m P in brush 20' N of line  
Continue random line for 1/2 sec through dense brush
- 720 Wire fence N & S. through dense brush
- 1360 Brushy draw course S.
- 2130 Summit Thick underbrush
- 27266 Det angle post and turn through thick brush R  $50^{\circ} 20'$
- S  $89^{\circ} 40' E$  2564 " " " " " " dense brush R  $18^{\circ} 18'$
- S  $21^{\circ} 22' E$  2631 " " " " " " brush S  $86^{\circ} 20'$
- N  $72^{\circ} 15' E$  3081 " " " " " " timber & brush S  $42^{\circ} 52'$
- N  $29^{\circ} 26' E$  3263 " " " " " " brush & timber R  $31^{\circ} 20'$
- N  $60^{\circ} 46' E$  3300 crossing a brushy hollow to middle branch of Pine Creek
- 3730 Cor for 1/4 S bet Decs 2 & 3 - I find original post & mound under N & S fence in burnt thicket of brush  
I set angle post at cor and turn on random line through center Dec 2 - var  $21^{\circ}$  Dense underbrush
- East 4616 Brushy draw runs SW. ascend through brush
- 5060 Summit - Dense growth of underbrush
- 52'80 Brush renders mound in practicable.
- 5338 A Tamarack in dense thicket of brush on line cut 3 notches on E & W. sides and 2 m on N face  
Continue random 1/2 sec line through dense brush
- 19'50 Brush less dense
- 23'48 A Red Fir about 30" dia on line cut 3 notches on E & W. sides  
A 1/2 sec cor in clump of brush bears N 19' dist
- 25'63 Det angle post at opening in brush and turn S  $68^{\circ} 40'$
- 2960 " " " " E of brush thicket and turn  $38^{\circ} 22'$
- N  $21^{\circ} 40' E$  3470 Leaving fence on line bet Dec 1 & 2 brush open
- N  $59^{\circ} 42' E$  3477 Det angle post and turn through timber and brush R  $75^{\circ} 55'$
- 4130 Enter very dense brush and thick timber
- 5265 I intersect a random line which I had run through the brush East on var  $21^{\circ}$  from 1/4 S cor bet Decs 1 & 2.  
I drive post at intersection marked AA and turn on var  $21^{\circ}$
- East 52'80 Det 3 m P. in Brush 20' N of line  
Continue random center Dec line through thick brush
- 45'55 Benj H's offers house bears S about  $200'$  brush cleared away

Trans June 2

Filed W.T.

- 14314 Drive stake for temp center sec 1 in thick brush & timber
- 73111 Set angle stake and turn through dense brush 32° S
- 7541 " " " " " 32° R Through brush more open
- 3358 " " " " " 32° R " Thick brush
- 4098 " " " " " 32 L Through timber & brush
- 4519 Probable 1/2 deer but sees 196 in open brush
- 5280 A Red fir 14" dia on line cut 4 m on South side and 3 no other E.S.W. I continue East on random center sec 6 & 3 NR 37E brush very thick
- 3788 An exceedingly brushy ravine runs S
- 4018 Set angle post and turn 2 19° Through heavy brush
- 4548 An original 1/2 ac bearing tree - brush cleared away
- 4568 A Sawraek 14 1/2 dia marked R 337 for terminus of road Brush cleared away so that I can see Doble's Saw mill which I find to be 150 East of terminus. I have heard the sound of the saw for 200 or 300 ft back in the brush This is an extremely brushy road

I hereby certify that the foregoing are the correct field notes of the survey of road No 337 for Umatilla Co Or the brushiest road I ever was on  
 Geo. L. Arnold Surveyor.

Filed July 10-1890 }  
 W. M. Pierce Clerk

I hereby certify the following to be a correct plat of the survey of Road 337 Township 37 N Range 36 & 37 East of the Willamette Meridian as made by me  
 June 28-29, 30-1890. Geo. L. Arnold Surveyor Umatilla County Oregon

→ Plat of Survey of Road No 337 ←

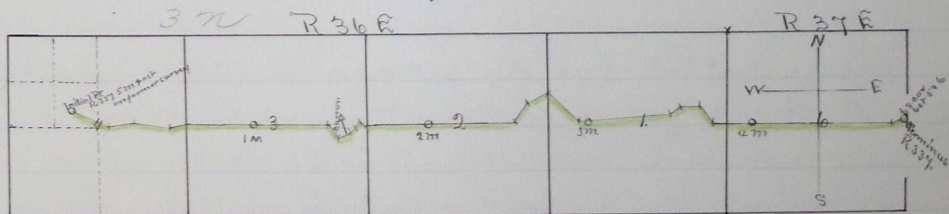

Filed July 10 1890 }  
 W. M. Pierce Clerk

July 16 1890 H 593