

Plat of Road No. 422

I hereby certify the following to be a correct plat of the
Survey of Road 422 Township 2 N. Range 32 E. East of Willam-
ette Meridian as made by me Apr. 26 1893

Geo. C. Arnold.

Surveyor for Multnomah County Oregon

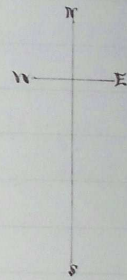
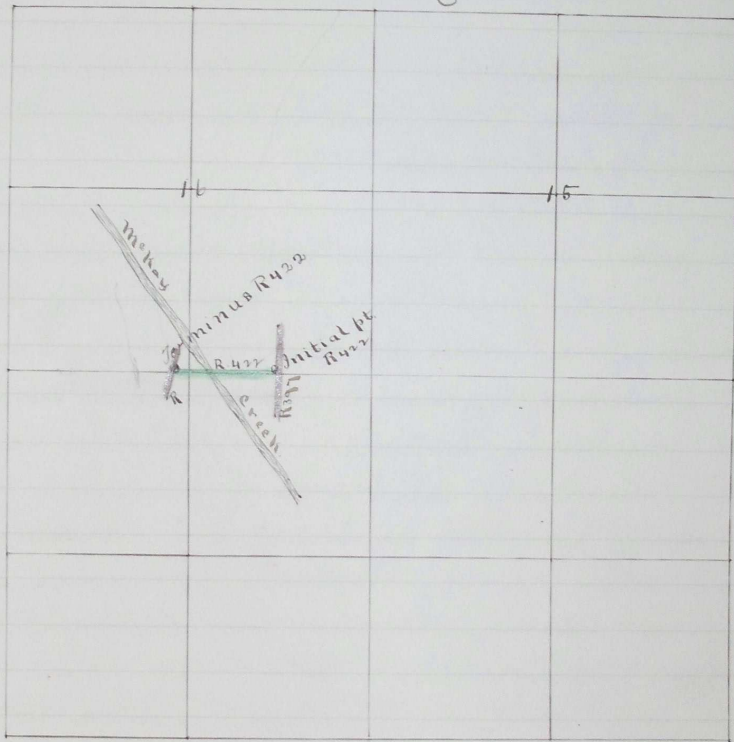

Filed May 3. 1893 }
 W. M. Penco }
 Clerk }

1482