

Plat of Road No 277

I hereby certify the following to be a correct plat of Road survey No 277 in Township 4 S. Range 31 & 32 East of Willamette Meridian as made by me Nov 3rd 4th 1886.

Jno. C. Arnold
Surveyor for Umatilla County,
Oregon

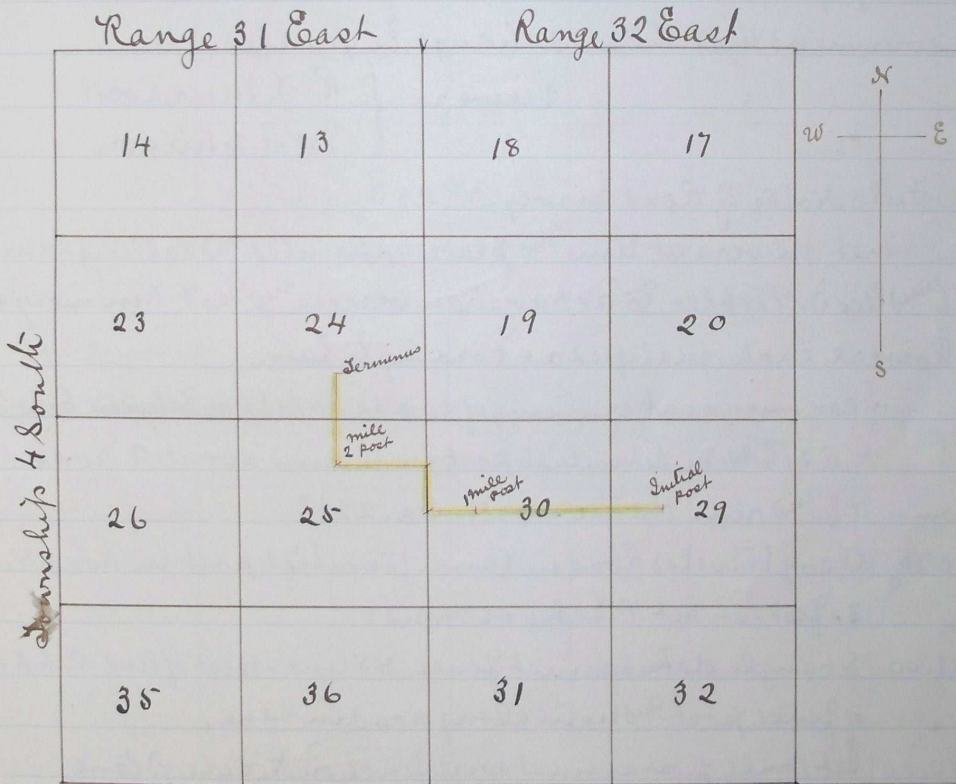

Journal G. page 396
" G " 472

Recorded me 19th 1887
G. A. Hartman, Clerk
By J. H. Parkes, Deputy