

ROAD NO
236

Report of Viewers, Field Notes and Plat of Survey of a change in County Road leading from Pilot Rock to Alba Cabin. Road No 236.

Report of Viewers

To the Hon County Court, Umatilla Co., Oregon.

We the undersigned being appointed by your Hon. Body to view out a change in the County Road No 236. beginning near the Barney Cabin, and ending near the Blue Mountain Saw Mill, we met at the time and place appointed, and after being duly qualified by W. W. Caviness, Surveyor, we proceeded to view and survey said road as set forth in the order.

We find the proposed road to be a good and practicable route for a County Road, and respectfully ask that the petition for the same be granted.

This the 28th day of March A.D. 1883.

A. A. Boynton }
Sam J. Young } Viewers
C B Sturdivant }

Field Notes

To the Hon County Court, Umatilla Co., Oregon

I hereby certify that on the 27th day of March 1883, after qualifying A. A. Boynton, Sam J. Young & C B Sturdivant, viewers & John Popejoy and C. H. Donald chainmen & A. H. Parker, marker, I proceeded to survey of County Road as set forth in Road No 236, as described in the accompanying field notes.

Beginning at a point on a County Road near the Barney Cabin, set P, marked R, run S. 15° E. 33 R. thence S. 29 R. Angle S 20° W. 39 R. S. 10° W 73 R. W. 25° S. 40 R. S 20° W. 52 R. S 35° W 54 R. Set P, m I. Thence S 17° W. 74 R. S 44° W. 54 R. W 20° S 90 R. W 8° S. 64 R. S 30° W 38 R. Set P, m II. Thence on same Deg 48 R. S 44° W. 72 R. S. 30° E. 106 R. S 23° W 34 R. S 15° E 36 R. thence E 24 R. set P, m III. Thence on same Deg 24 R. S 10° E 92 R. S 40° E. 86 R. thence E to County road 64 R, about 20 R. S of Blue Mountain Saw Mill, set P, marked R.

Surveyed March 27th & 28th, 1883

Journal J. Page 687

.. S .. 31

Recorded April 28th 1883

J P Bushee
Clerk

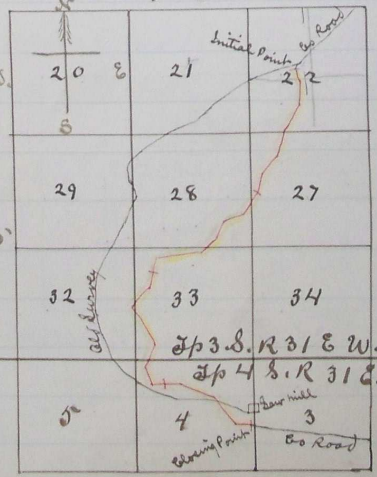

By W. W. Caviness

I hereby certify this to be a true plat of Road Survey No 236

Surveyed March 27th & 28th 1883

W. W. Caviness
Surveyor

Scale one inch to the mile