

East 80.00 set post marked 3m

" 80.00 " " " 4m

" 25.00 angle then

436°E 28.00 " "

1.77°E 32.00 " "

4.60°E 35.00 " "

East 52.00 set post marked R. at the NW cor of Sec 10 T4N R34E.

Chairman  
M J Kirkland  
L D Smith  
Marker  
George Garrett

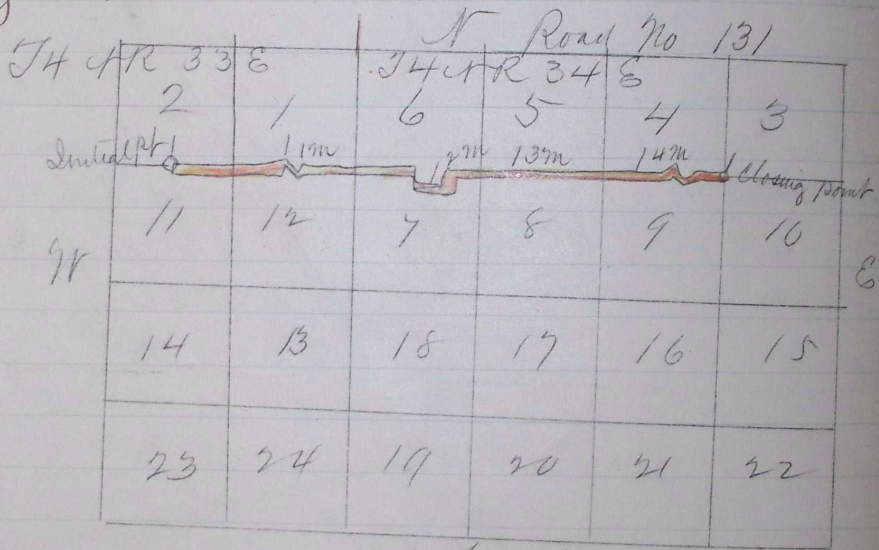

I hereby certify that the above is a true and correct survey and plat of the above named road  
Oct 10<sup>th</sup> 1882

A L Coffey  
County Surveyor  
Umatilla County Oregon

Four E page 500  
Four E page 537  
Four E page 589

ROAD T  
127