

Report. Plat & Field Notes of Co Road
 from N.W. Cor of S.W. 1/4 of N.E. 1/4. S. 22. S.
 1/4. N.R. 34. E. So S.W. Cor. S. 16. S. 1/4. N. R. 33. E

- Corner Road. 7mcs
- West 15 1/2
- West 80
- West 81 1/2 - 1
- " 320 - 2
- " 320 - 3
- " 320 - 4
- " 320 - 5
- " 320 - 6
- " 320 - 7
- " 240 - 7 3/4

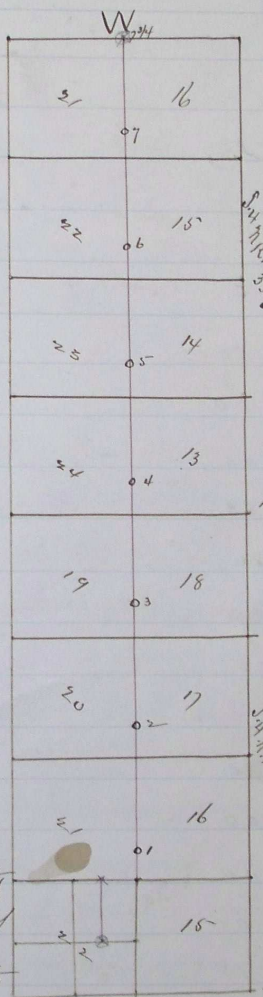

I certify the foregoing to be a correct copy of the field notes of the road surveyed by me from the N.W. Corner of S.W. 1/4 of N.E. 1/4 of Sec 22. S.W. 1/4 R. 34 E to S.W. Corner of Sec 16. S.W. 1/4 R. 33 E. together with a plat of said survey.

J. N. Raby Co Surveyor
 by J. H. Sharon Deputy

To the Stone County Court for the County of
 Wimaux State of Oregon.

We the viewers appointed at the July term of said Court to view out a report on a County road beginning at the N.W. Corner of the S.W. 1/4 of N.E. 1/4 of Sec 22. S.W. 1/4 R. 34 E. from thence to S.W. corner of S. 16 S.W. 1/4 R. 33. E. by leave to report

that we met at the home of D. Paylor on the 28th day of August 1879. as per order after being duly sworn proceeded in company with J. H. Sharon Dep^y Co Surveyor and the necessary assistants to view out survey of road off said road as by laws directed and we would recommend the establishment of the same as a County road in accordance with the prayer of the petitioners believing the same to be of public benefit. the plat & field notes are hereto annexed.

leave granted Sept 3rd 1879
 Filed Sept 4th 1879. Recorded Sept 13th 1879

Viewers { G. H. Reed
 J. M. Mansfield
 W. M. Willaly

J