

Rd#C-4

Field Notes (continued)

N 10 1/2° E	20 ch	set a post making angle A mounted
N 16 3/4° E	15 "	set 4 mile stake on E side of Crav. R. mounted & marked 4 M
N 16 3/4° E	7 "	on same course, set post making angle on E side of Crav. R.
N 13 1/2° E	7 3/4 "	set 3 mile post for 4x4-4 well subtended & marked 5 M
N 1 1/2° E	3 1/2 "	on same course, crossing gulch, set angle post, mounted 2 ch south of rocky bluff - changed course
N 5 1/2° E	11 1/2 "	set angle post on A near title but. Geo. Post & Mr. Strigate
S 55 3/4° E	10 1/2 "	" " " mounted, E. of Dr. Blalock's fence
N	2 1/2 "	South side of Sea Swift's fence
N	20 1/2 "	S. W. corner of Geo. Swift's land claim, Rock in center case
N 10° E	18 "	set 6 M post on W. side of Crav. R. in lane mounted 6 M
N 20° E	50 "	set 7 M post W. of center of lane, mounted, marked 7 M.
N 40° E	20 "	on same course, set angle post W. of center of lane, mounted
N 20° E	60 "	set 8 M post, in hollow, about center of lane, mounted 8 M
N 20° E	45 "	on same course, set post making angle by A - center of lane
N 5° E	13 1/2 "	set termination at intersection of boundary line

between Oregon & Washington (Dey)

Survey begun Monday May 20 and completed Wednesday May 22nd 1878

Geo. C. Arnold

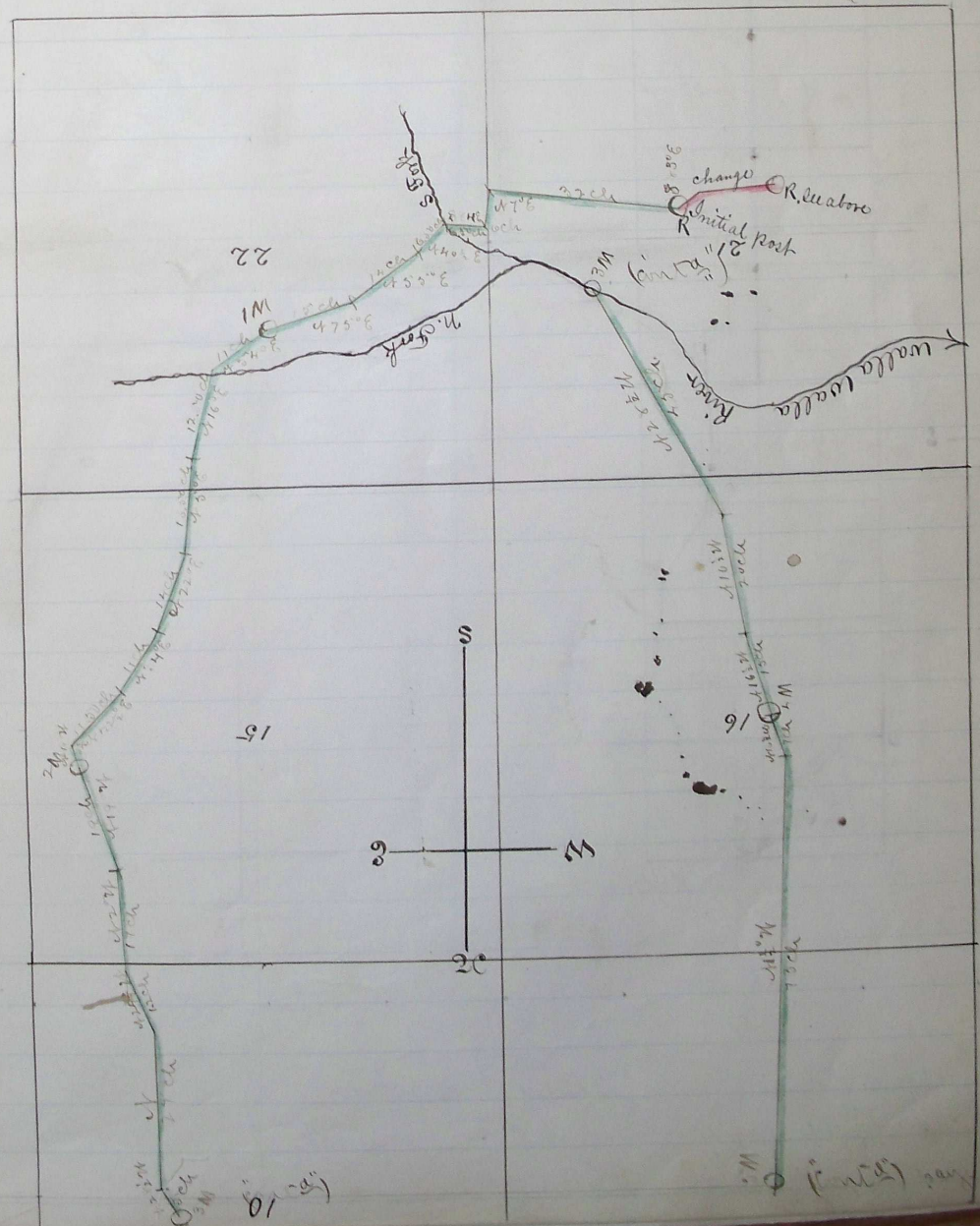
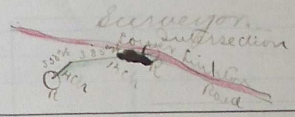

The copy Co. Clerk has recorded this road plat on a scale of 4 ins. = 1 mile, in a crowded manner, leaving the book wrong end up and I can not put sections in, properly; so, I have replatted, on smaller scale, the same road, from original notes. Geo. C. Arnold.

Oregon
 river
 city
 road
 order
 equal-
 the
 a de-
 got
 ton.
 able
 body
 mitted

 at
 center

 starting point
 on declivity

 N. Riv.
 d. R.

 igh of
 course
 about
 yle
 ended

 " "
 " "
 ound
 ended
 ounded

 408 4 1/2 ch.
 (miled)