

Land claim.

J. H. Sharon

County Surveyor

Walla Walla Co. Wn.

Plat # 34

Plat of Road passing U.S. mill



Co. Road near Pattersons

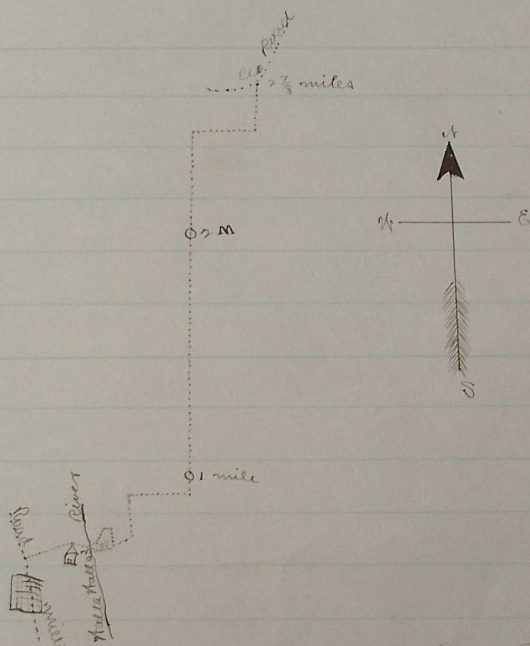

Scale matches to the mill

I certify the above is a correct plat
of the road as surveyed by me com-
mencing at road running from
Walla Walla to Weston near Milton
and running past U. S. mills thence
cross Walla Walla river thence to
intersect Co. road near J. Pattersons

J. H. Sharon
Co Surveyor

Road granted and located July 9th 1874
See Co. Court Journal "B" page 436