

notes as taken by me of the road running from J Nelsons to Co line near  
Mc Donalds, survey commenced Feb 10<sup>th</sup> 1874 as per order of Co Court  
J. H. Sharon  
Co. Surveyor.

Part of Road from Nelsons  
to

State line near Mc Donalds  
R 30 E

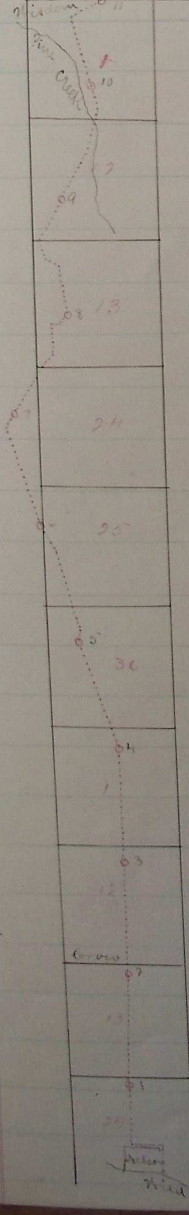
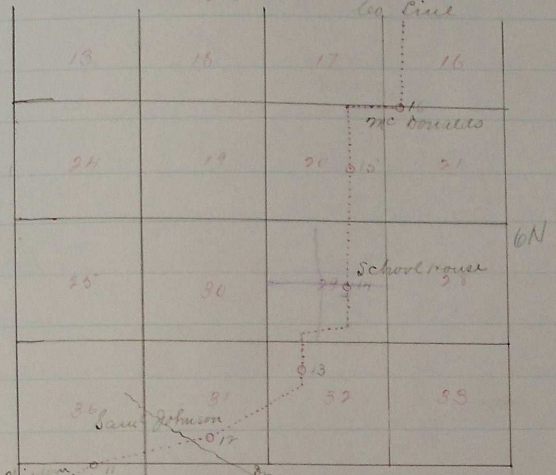

I certify that the accompanying plat  
is correct as taken from the field notes of  
the survey of the road from Nelsons on  
Wild Horse Creek to Co line near Mc Donalds

J. H. Sharon  
Co Surveyor

Road granted and located April 9<sup>th</sup> 1874  
See Co. Court Journal B page 400.