

Plot of Road from Pilot Rock via Cus

Rd #32

to

Road from Pendleton to Humphreys

Range 326

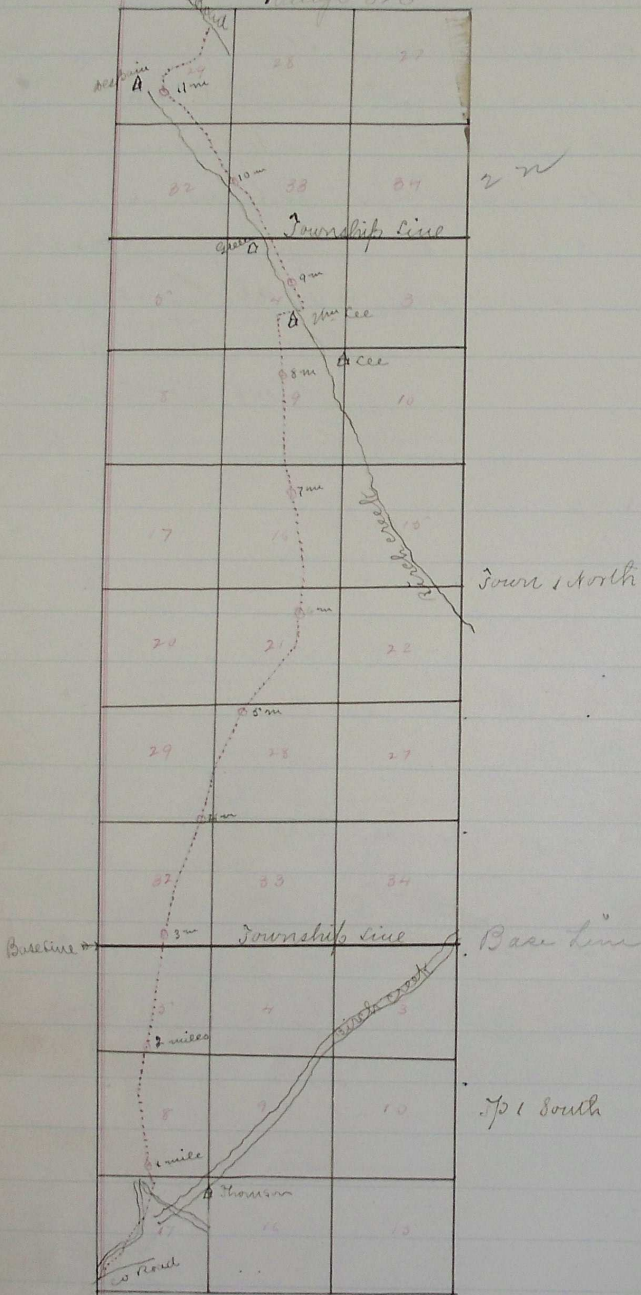

I certify that the foregoing are the correct field notes & plot of the extension of Co. Road running from Western Boundary of Humatia Co. via the upper forks of Willow creek to Pilot Rock, as ordered of Co. Court at April term

J. W. Sharon

Chairman { W. W. Carpenter  
A. Fletcher

Surveyor

Road granted located July 31<sup>st</sup> 1872  
See Co. Court Journal "B" page 2073