

Map of Road from Tmatilla city

30

Blue Mts. via McKay cr.

Range 28

I hereby certify that the following is a correct plot of the road leading from Tmatilla city to the summit of the Blue mountains as taken from the field notes of J. H. Stevenson Surveyor

Township 6 North

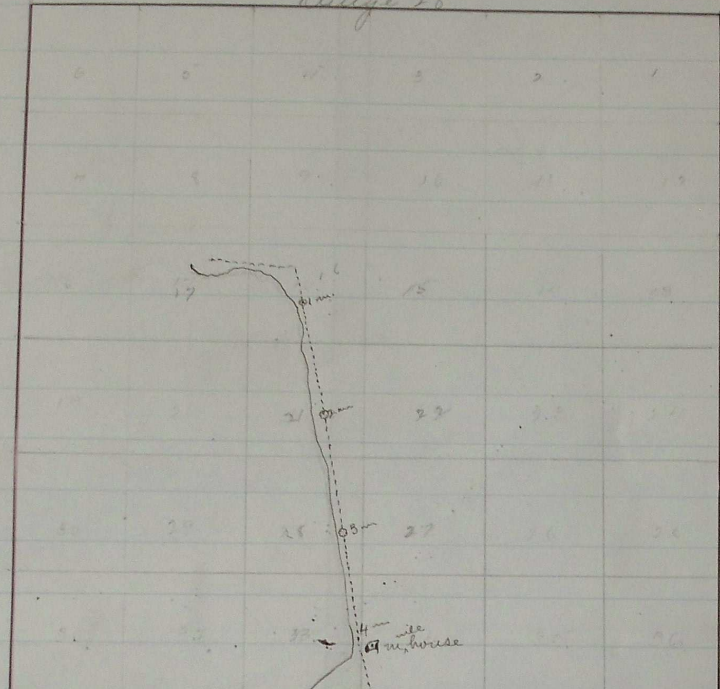

Range 29

Township 8 N

mountain

road to
105/500 ft.

Township 8 North

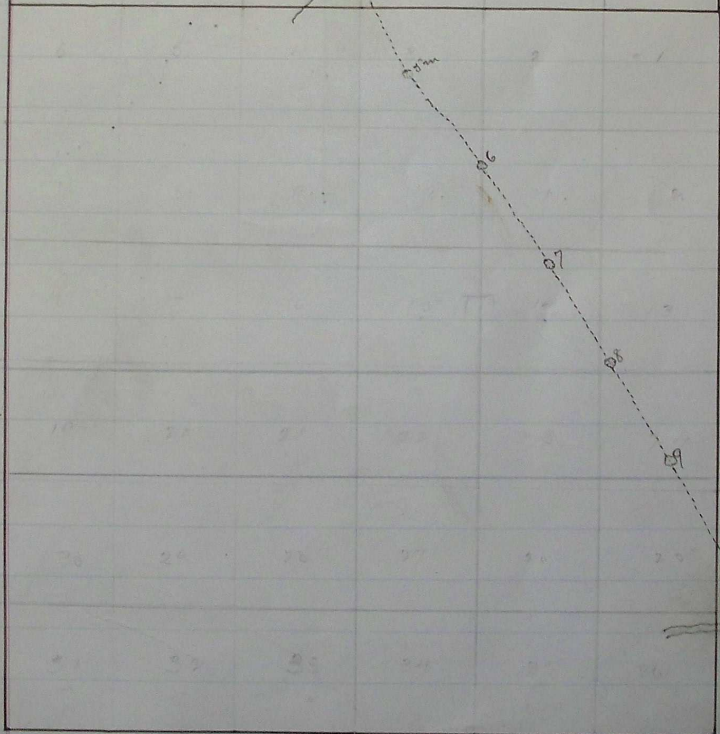

Range 29

37
38

(continued to p. 31)